

**Architectural and Site Design Review Committee
PROPOSALS FOR ASDRC SUBCOMMITTEE**

Applicant can seek one of the following reviews from the ASDRC Subcommittee:

Informal Review of Concept Plan

Decision on Review Level: Insignificant Change approved Administratively by Chairman,
Minor Change approved by ASDRC Subcommittee, or Full Review by ASDRC.

APPLICATION TYPE: Regulatory Review Advisory Review

DESIGN AREA: Town Center Village District Town Center Upper Main Street
 Putnam/Glastonbury Blvd Naubuc Ave/Pratt St Lower New London Tpke
 Reserved Land Other Area

APPLICATION: New Construction Addition Exterior Renovation
 Other: Signs

Please Submit **4** copies of the application and materials.

Please return this form and any enclosures to the Community Development Office, 2155 Main Street
Post Office Box 6523, Glastonbury, CT 06033-6523.

TITLE/ADDRESS OF APPLICATION: 2450 Main St.

APPLICANT'S NAME: Graphik Sign Solutions, LLC

APPLICANT'S ADDRESS: 36 G - Kreiger Lane, Glastonbury

PHONE #S: 860-657-9755 860-682-5098 (cell)

EMAIL: gis@snet.net

OTHER REPRESENTATIVE(S): _____

STATEMENT OF INTENT: tenant

Continue unified sign program
to East end of Building. Please see
attached. Remove existing Fraleigh Gray & Java Salon
letters.



APPLICANT'S SIGNATURE

10/29/2024
DATE

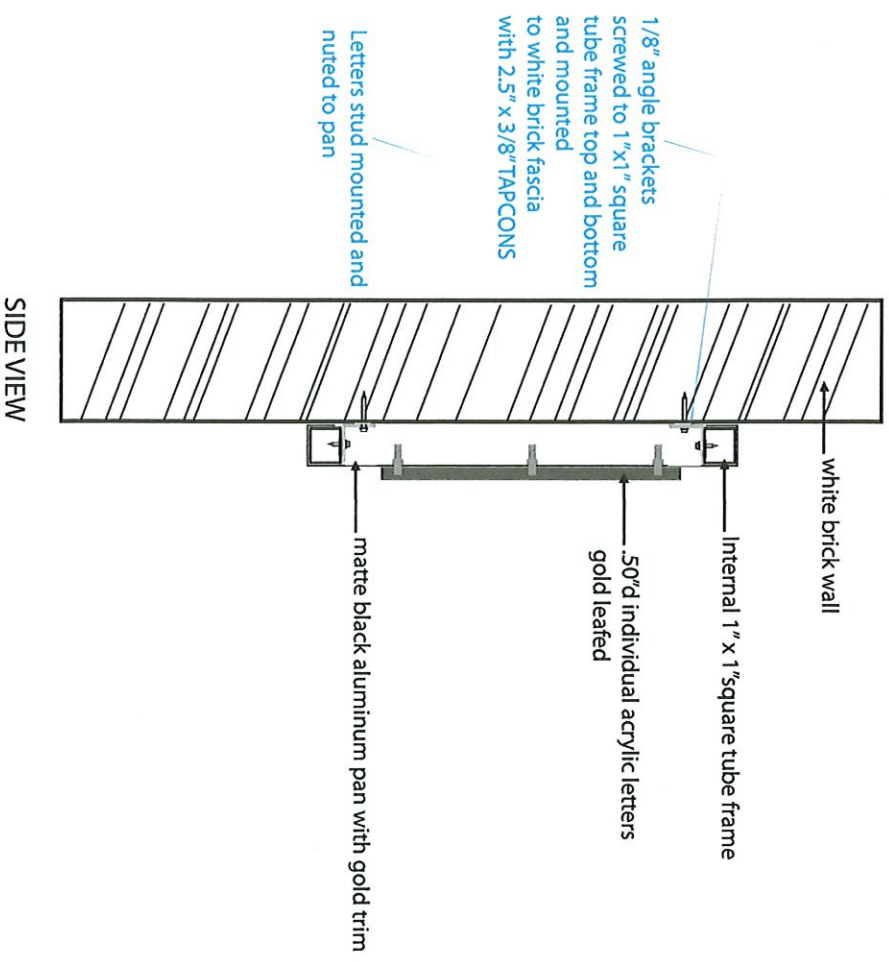

Typical Wall Sign: 21" x 168"x1"d

.063 Aluminum 1" pan finished matte black with internal 1" x 1" square tube support frame, gold anodized angle trim with .50"d individual letters finished with 24kt. gold leaf.



GRAPHIK
SIGN SOLUTIONS LLC
SIGNAGE & BRANDING PROFESSIONALS

36G Kreiger Lane
Glastonbury, CT 06033
860.657.9755

ARCHITECT/DESIGN

KMK

CLIENT

Rooted play studio

APPROVED APPROVED AS NOTED
 DISAPPROVED - REVISE & RESUBMIT

PROJ. MANAGER

Karin Knobel

JOB NAME / LOCATION

Rooted play studio
2450 Main Street
Glastonbury, CT

PROJECT

Wall Sign

INSTALLATIONS

Wall Sign

DWG. NO. REF. DWG.

3410RPS-WS

DATE SHEET
9.9.24 1 of 1

REVISION NO. 1

Welles St.

Glastonbury KICKBOXING

TYPICAL WALL SIGN

Existing letters
to be removed

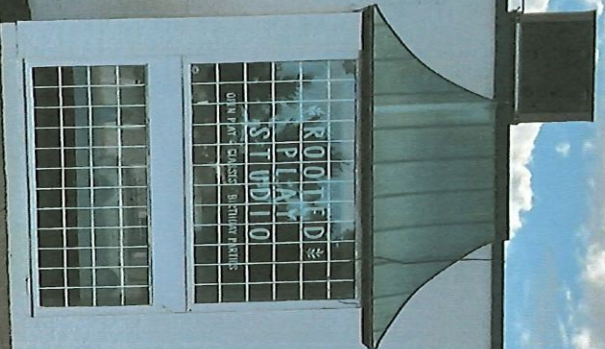

TEASE Hair Salon

TYPICAL WALL SIGN

Existing letters
to be removed





ROOTED play studio

Future Tenant

TYPICAL WALL SIGNS
2-required



FAMILY DENTAL

FRESH **baya's** GRILL

2450

verity

Par



2450 Main St

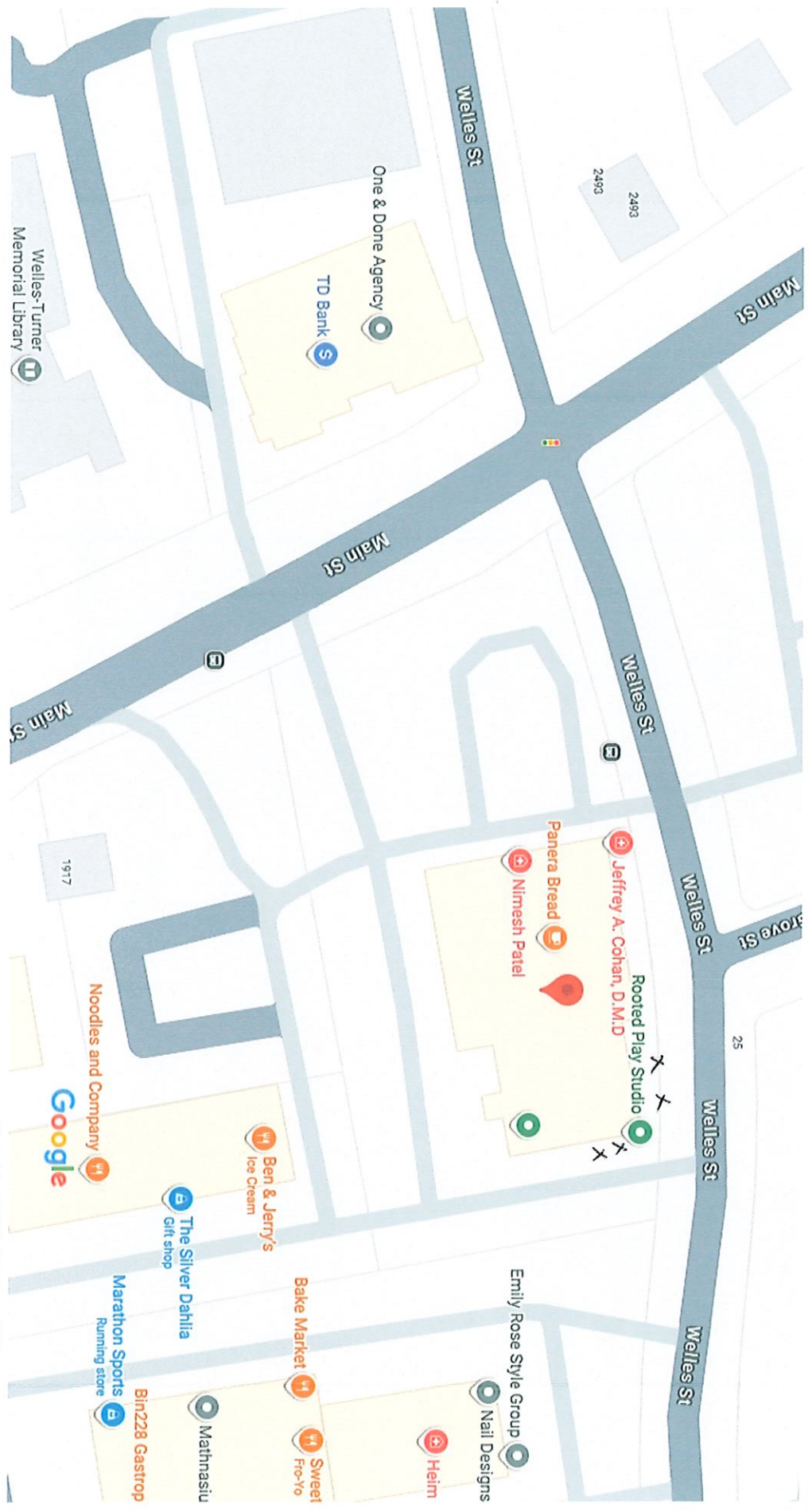

Map data ©2024 Google 50 ft

Existing lettering to remain. Any future tenant leasing the space would be required to replace letters with typical black and gold leaf sign as per approved unified sign program.

GLASTONBURY FAMILY DENTAL

NIMESH L. PATEL, DMD ♦ JEFFREY A. COHAN, DMD

