

GENERAL NOTES

- PROPERTY LINE DATA FROM MAPS ENTITLED "PREPARED FOR BRUCE SCHER" GLASTONBURY, CT. 06033 SCALE 1"=40' BY Nelson & Hyppa Civil Engineers; "PREPARED FOR BRUCE SCHER GLASTONBURY, CT. 06033 SCALE 1"=40' BY Nelson & Hyppa & Associates Civil Engineers and Land Surveyors" Detail 4-2-85
- EROSION AND SEDIMENTATION CONTROL MEASURES FOR THIS PLAN ARE OUTLINED ON SHEET 2 OF 2.
- ALL CONSTRUCTION IS TO CONFORM TO TOWN OF GLASTONBURY REQUIREMENTS.

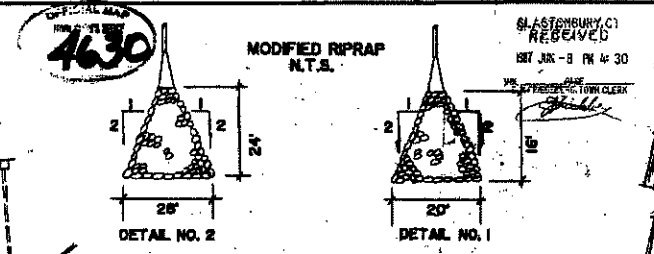

N F
M & S Security, Inc.

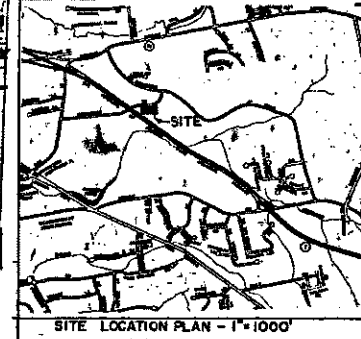
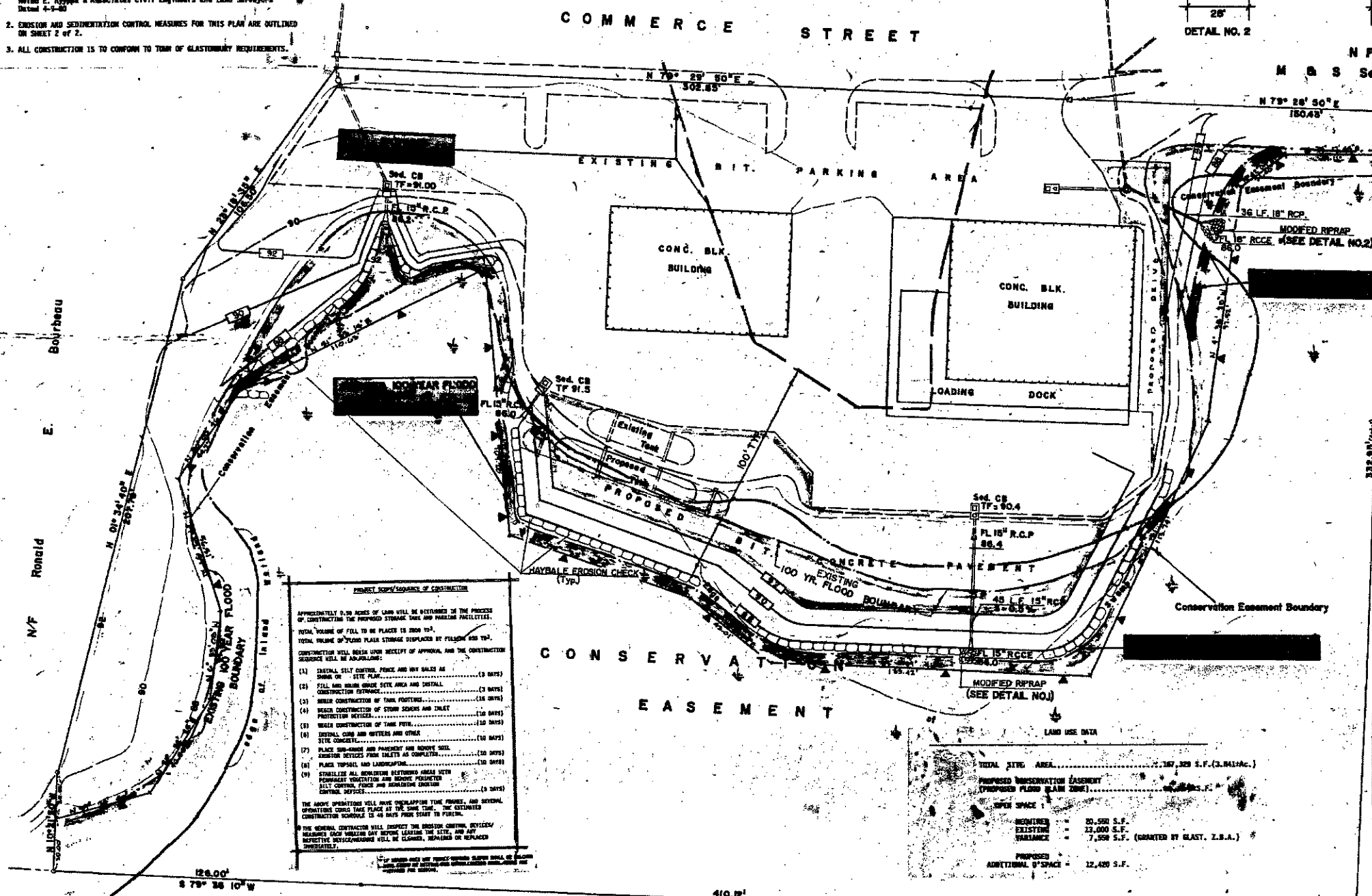

PROJECT SCHEDULE OF CONSTRUCTION

APPROXIMATELY 8,000 ACRES OF LAND WILL BE REQUIRED IN THE PROCESS OF CONSTRUCTION OF PROPOSED STORAGE TANKS AND PARKING FACILITIES.

TOTAL VOLUME OF FILL TO BE PLACED IS 200 Y³.

TOTAL VOLUME OF FLOOD PLAIN STORAGE DISPLACED BY FILLING IS 10 Y³.

CONSTRUCTION WILL BEGIN UPON RECEIPT OF APPROVAL, AND THE CONSTRUCTION SEQUENCE WILL BE AS FOLLOWS:

- (1) INSTALL SELF PROTECTIVE FENCE AND SIGN BARRIERS (3 DAYS)
- (2) FILL AND GRAD DRIVEWAY AREA AND INSTALL CONSTRUCTION ENTRANCE (10 DAYS)
- (3) BEGIN CONSTRUCTION OF TANK FOOTINGS (10 DAYS)
- (4) BEGIN CONSTRUCTION OF TANK SEWERS AND TANK PROTECTION DEVICES (10 DAYS)
- (5) BEGIN CONSTRUCTION OF TANK PILING (10 DAYS)
- (6) INSTALL CURB AND WALKERS AND OTHER SITE CONCRETE (10 DAYS)
- (7) PLACE SIGNAGE AND PARKING AND DRIVEWAY. FINISH SERVICES FROM TANKS AS COMPLETE (10 DAYS)
- (8) PLACE TOPSOIL AND LANDSCAPING (10 DAYS)
- (9) STABILIZE ALL REMAINING EXISTING GRASS WITH PERMANENT VEGETATION AND REMOVE EXISTING SILT CONTROL, FENCE AND REMAINING EXISTING CONSTRUCTION SERVICES (5 DAYS)

THE ABOVE OPERATIONS WILL HAVE OVERLAPPING TIME FRAMES, AND SEVERAL OPERATIONS COULD TAKE PLACE AT THE SAME TIME. THE ESTIMATED CONSTRUCTION SEQUENCE IS 45 DAYS FROM START TO FINISH.

THE GENERAL CONTRACTOR WILL INSPECT THE EROSION CONTROL DEVICES/MEASURES EACH WEEKEND DAY BEFORE LEAVING THE SITE, AND ANY DEFECTIVE WORK/MEASURES WILL BE CORRECTED, REPAIRED OR REPLACED IMMEDIATELY.

LAND USE DATA

| | |
|--|--|
| TOTAL SITE AREA | 2,787,329 S.F. (2.811 AC.) |
| PROPOSED CONSERVATION EASEMENT (PROPOSED FLOOD PLAIN ZONE) | 1,100,000 S.F. |
| SPACE | |
| EXISTING | 20,500 S.F. |
| PROPOSED | 23,400 S.F. |
| TOTAL | 43,900 S.F. (GRANTED BY GLAST. Z.S.A.) |
| PROPOSED ADDITIONAL SPACE | |
| | 12,400 S.F. |

N F
Monoco & Sons Paving, Inc.

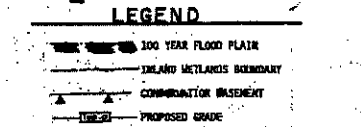

GRADING/EROSION CONTROL PLAN

PREPARED FOR
BEMER PETROLEUM PROD.
210 COMMERCE ST.
GLAST., CT. Scale: 1"=20'
Sept. 10, 1986

I HEREBY CERTIFY THIS MAP AND SURVEY WERE PREPARED IN ACCORDANCE WITH THE STANDARDS OF A CLASS "D" SURVEY AS DEFINED IN THE CODE OF PRACTICE FOR STANDARDS OF ACCURACY OF SURVEYS AND MAPS ADOPTED 12-10-75 AS AMENDED BY C.A.L.S. *Richard F. Lynn*



N F Storage Park Assoc.
C/O Mikel Ring

APPROVED: April 7, 1987
SPECIAL PERMIT, SECTION: 4.11 and 12
TRZ CHAIRMAN OR SECRETARY: *[Signature]*
DIR. OF COMMUNITY DEVELOPMENT: *[Signature]*
DIR. OF PUBLIC WORKS: *[Signature]*



OFFICIAL SEAL
4630
CERTIFIED BY:
Richard F. Lynn



DRAWING NUMBER
4630

DRAWING NUMBER
4630

DRAWING NUMBER
4630

DRAWING NUMBER
4630



87-21