

FILE: H:\DWG\Streets\Bell St\PW-2013 Bell Street Sidewalk Base Plan\BELL STREET SIDEWALK BASE PLAN - DESIGN.dwg USER: Macdonald-ansib DATE: 7/6/2023

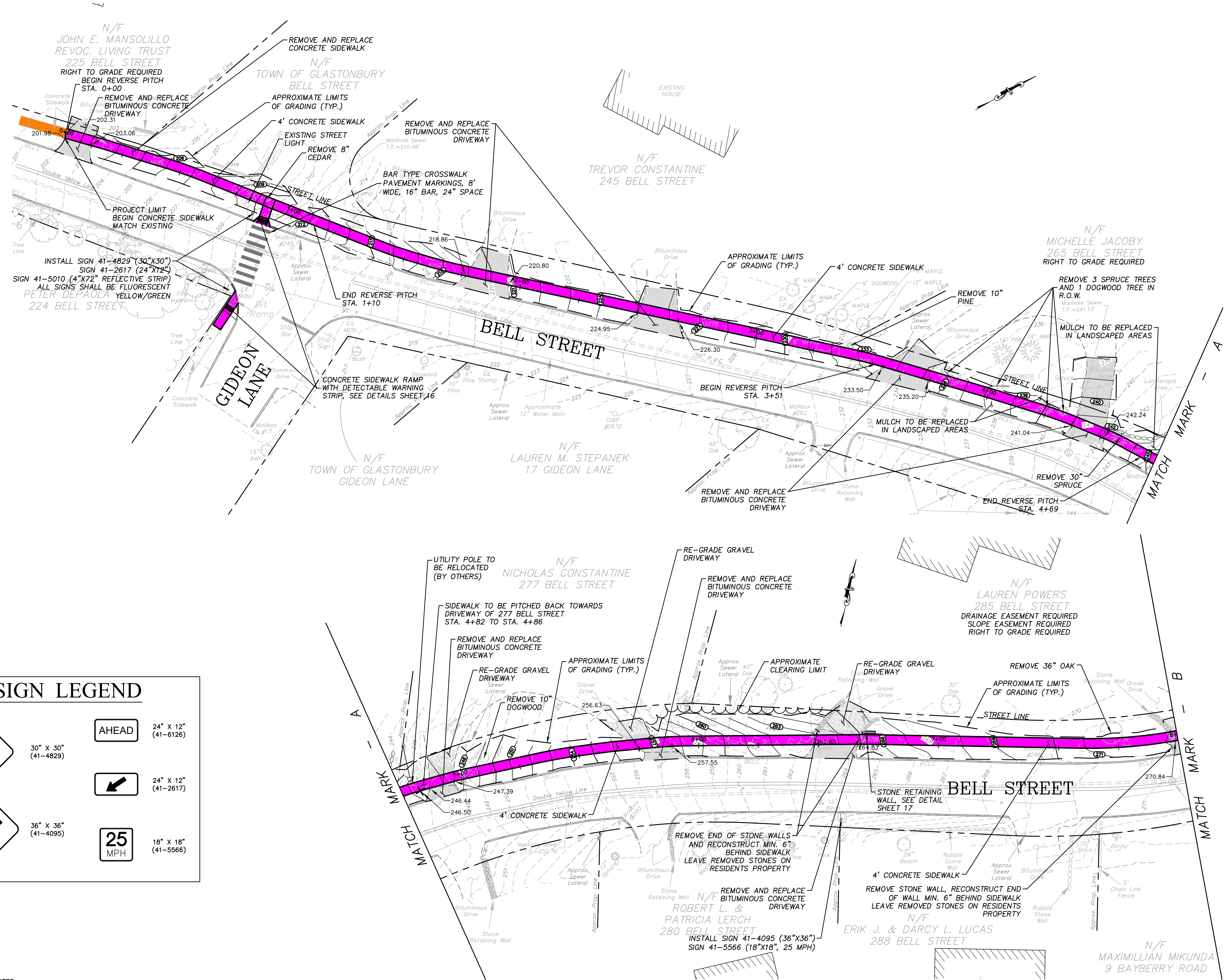

SIGN LEGEND

	30" X 30" (41-4829)		AHEAD 24" X 12" (41-6126)
	36" X 36" (41-4095)		25 18" X 18" (41-5566)

NOTE:
 LOCATION OF FEATURES AND CONTOUR DATA DEPICTED HEREON WERE ACQUIRED BY FIELD SURVEY ON JUNE 2019.
 THERE IS NO BOUNDARY/DETERMINATION OPINION.
 NO EASEMENTS PERTAINING TO THE SUBJECT PARCEL ARE DEPICTED HEREON.
 NOT ALL IMPROVEMENTS ARE DEPICTED HEREON.
 HORIZONTAL CONTROL IS BASED ON THE CONNECTICUT GEODETIC SURVEY STATE PLANE COORDINATES, NORTH AMERICAN DATUM OF 1983 - (NAD83).
 ELEVATIONS AND VERTICAL CONTROL IS BASED ON THE NORTH AMERICAN VERTICAL DATUM 1988 - (NAVD88).

THE LOCATION OF UNDERGROUND UTILITIES DEPICTED HEREON ARE BASED ON FIELD LOCATIONS AND BY INFORMATION PROVIDED BY OTHERS. THEIR TRUE LOCATIONS MAY VARY FROM THOSE INDICATED, AND ALL UNDERGROUND UTILITIES MAY NOT BE SHOWN. IF APPLICABLE, UTILIZE THE "CALL BEFORE YOU DIG" NUMBER (1-800-922-4455), TO VERIFY THE LOCATION OF ALL UNDERGROUND UTILITIES, AND RESOLVE CONFLICTS PRIOR TO STARTING CONSTRUCTION, REPAIR OR DESIGN.

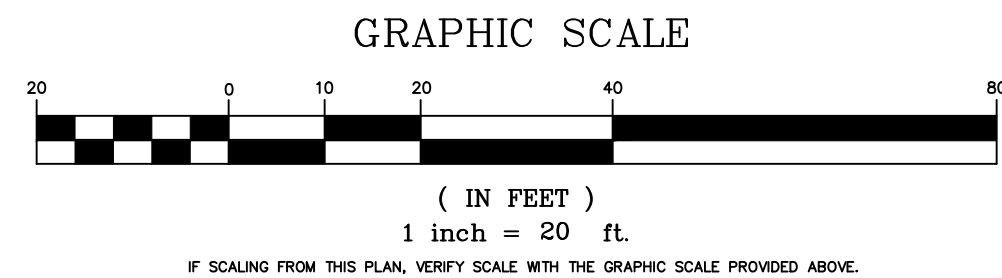

PW-2013

DRAWING ISSUE STATUS		
NO.	DESCRIPTION	DATE
1.	ISSUED FOR PERMITTING	05/11/2023

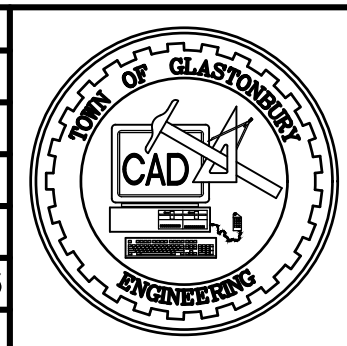

SCALE: AS SHOWN	DATE:
DRAWN BY: M.L.A.	05/11/2023
CHECKED BY: S.M.B.	05/11/2023
APPROVED BY: D.A.P.	05/11/2023
ST. FILE:	

DO NOT SCALE THIS DRAWING. USE THE DIMENSIONS GIVEN. IF THERE ARE ANY DISCREPANCIES OR QUESTIONS, CONTACT THE TOWN OF GASTONBURY, ENGINEERING OFFICE.

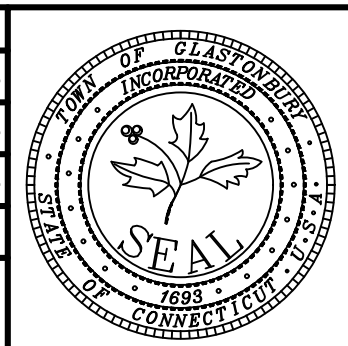

PRELIMINARY

SITE PLAN DEPICTING
 PROPOSED SIDEWALK IMPROVEMENTS
 LOCATED ON
 BELL STREET
 GASTONBURY, CONNECTICUT

SHEET NO.
1
 OF 4

FILE: H:\DWG\Streets\Bell St\PW-2013 Bell Street Sidewalk Base Plan - DESIGN.dwg USER: Mactozar-anshb DATE: 7/6/2023

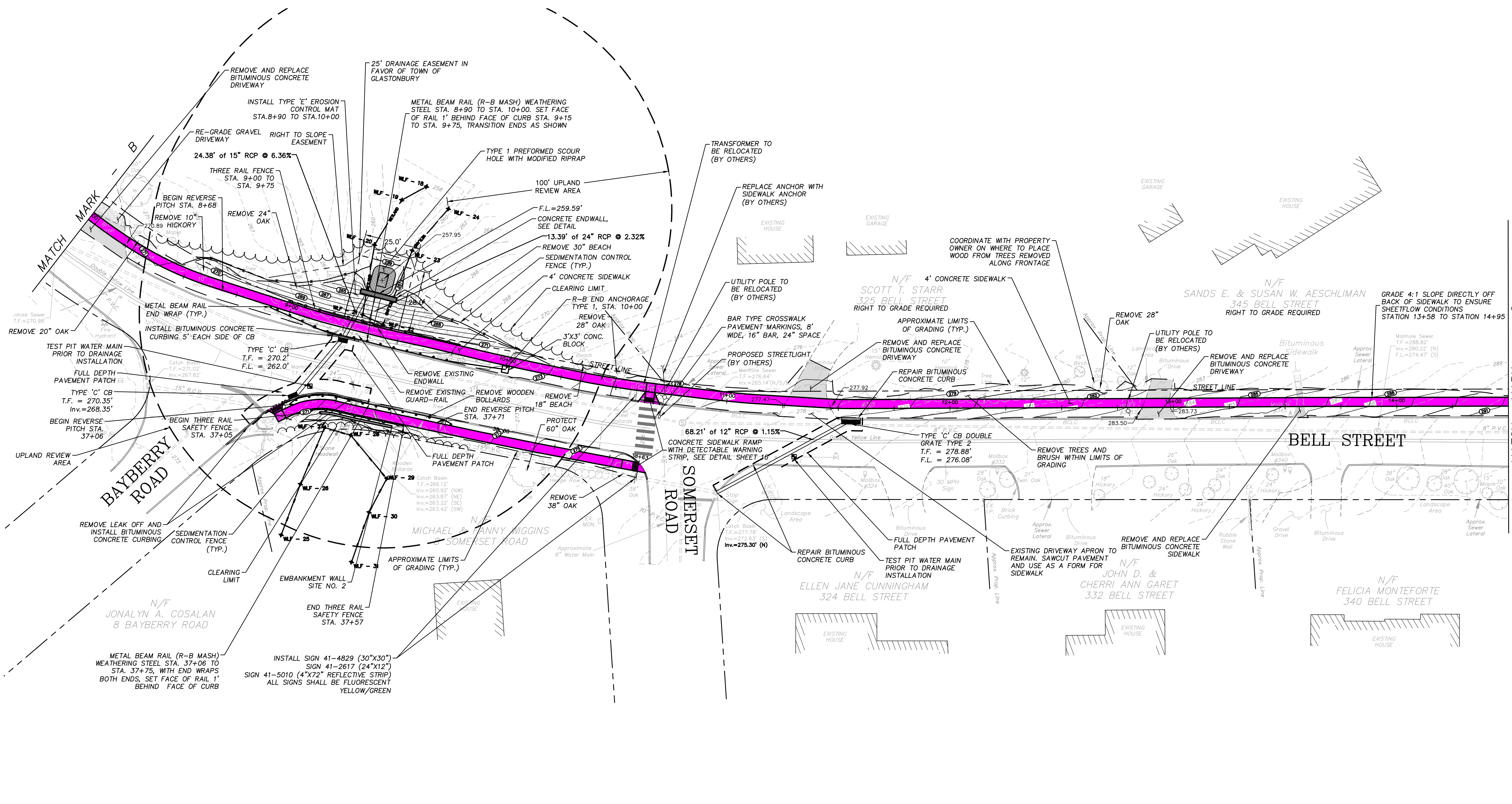

NOTE:
 LOCATION OF FEATURES AND CONTOUR DATA DEPICTED HEREON WERE ACQUIRED BY FIELD SURVEY ON JUNE 2019.
 THERE IS NO BOUNDARY/DETERMINATION OPINION.
 NO EASEMENTS PERTAINING TO THE SUBJECT PARCEL ARE DEPICTED HEREON.
 NOT ALL IMPROVEMENTS ARE DEPICTED HEREON.
 HORIZONTAL CONTROL IS BASED ON THE CONNECTICUT GEODETIC SURVEY STATE PLANE COORDINATES, NORTH AMERICAN DATUM OF 1983 - (NAD83).
 ELEVATIONS AND VERTICAL CONTROL IS BASED ON THE NORTH AMERICAN VERTICAL DATUM 1988 - (NAVD88).

THE LOCATION OF UNDERGROUND UTILITIES DEPICTED HEREON ARE BASED ON FIELD LOCATIONS AND BY INFORMATION PROVIDED BY OTHERS. THEIR TRUE LOCATIONS MAY VARY FROM THOSE INDICATED, AND ALL UNDERGROUND UTILITIES MAY NOT BE SHOWN. IF APPLICABLE, UTILIZE THE "CALL BEFORE YOU DIG" NUMBER (1-800-922-4455), TO VERIFY THE LOCATION OF ALL UNDERGROUND UTILITIES, AND RESOLVE CONFLICTS PRIOR TO STARTING CONSTRUCTION, REPAIR OR DESIGN.

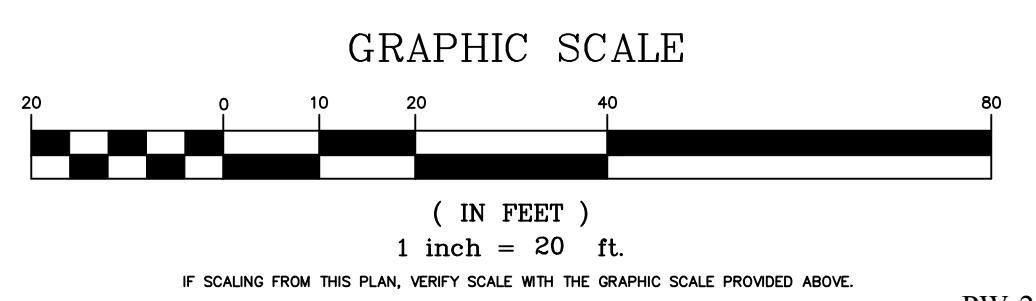

DRAWING ISSUE STATUS		
NO.	DESCRIPTION	DATE
1.	ISSUED FOR PERMITTING	05/11/2023

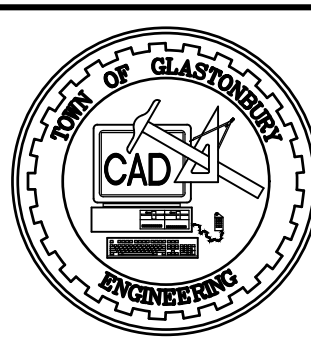

SCALE: AS SHOWN	DATE:
DRAWN BY: M.L.A.	05/11/2023
CHECKED BY: S.M.B.	05/11/2023
APPROVED BY: D.A.P.	05/11/2023
ST. FILE:	

DO NOT SCALE THIS DRAWING. USE THE DIMENSIONS GIVEN. IF THERE ARE ANY DISCREPANCIES OR QUESTIONS, CONTACT THE TOWN OF GLASTONBURY, ENGINEERING OFFICE.

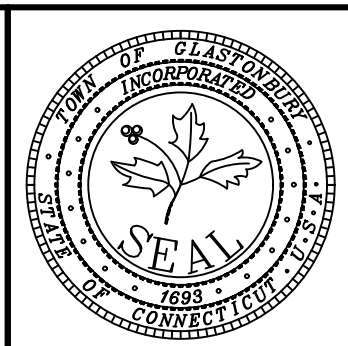

PRELIMINARY

SITE PLAN DEPICTING PROPOSED SIDEWALK IMPROVEMENTS LOCATED ON BELL STREET GLASTONBURY, CONNECTICUT

SHEET NO. **2** OF 4

FILE: H:\DWG\Streets\Bell St\PW-2013 Bell Street Sidewalk Base Plan - DESIGN.dwg USER: Macdonald-ansh Date: 7/6/2023

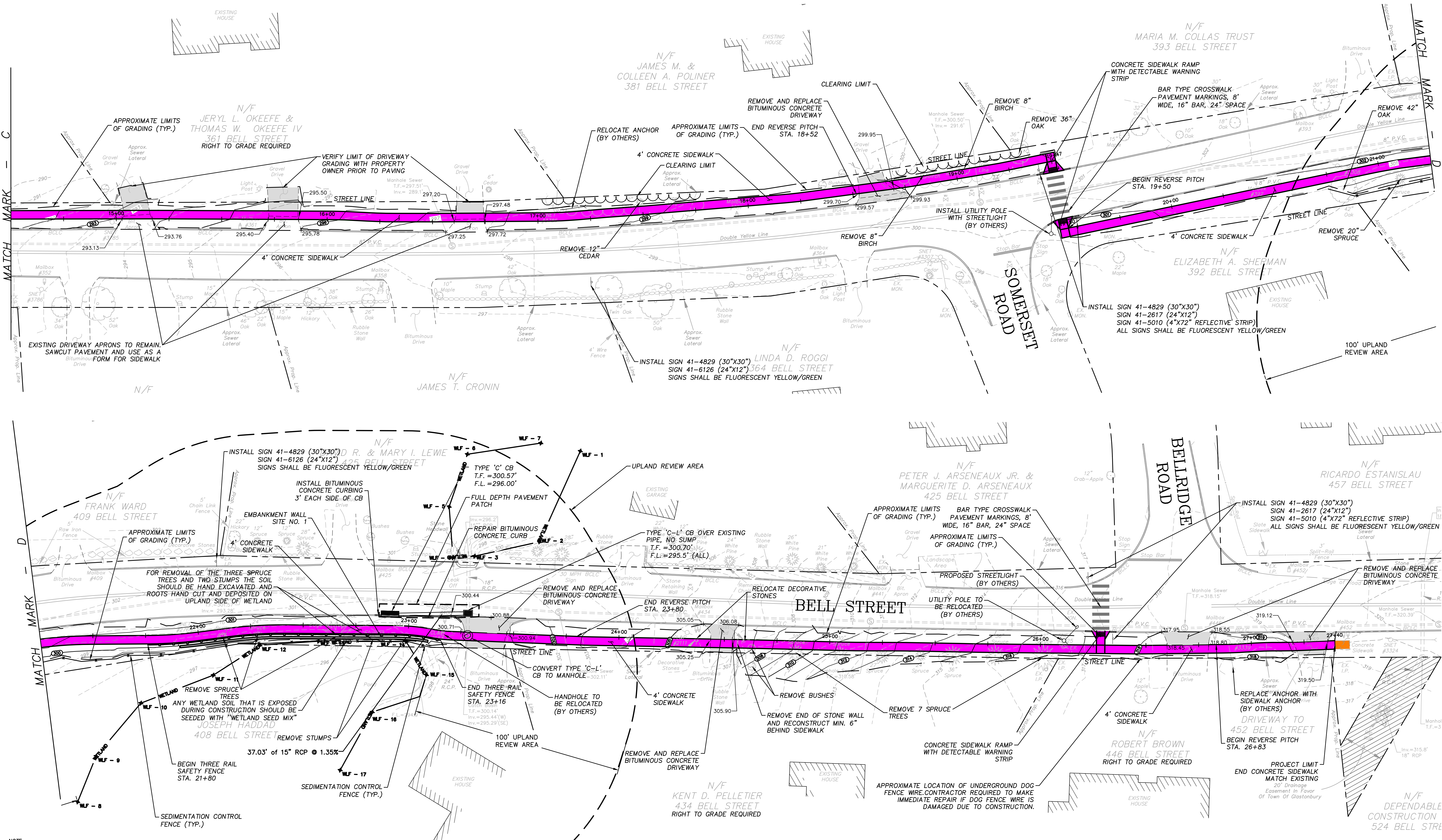

NOTE:
 LOCATION OF FEATURES AND CONTOUR DATA DEPICTED HEREON WERE ACQUIRED BY FIELD SURVEY ON JUNE 2019.
 THERE IS NO BOUNDARY/DETERMINATION OPINION.
 NO EASEMENTS PERTAINING TO THE SUBJECT PARCEL ARE DEPICTED HEREON.
 NOT ALL IMPROVEMENTS ARE DEPICTED HEREON.
 HORIZONTAL CONTROL IS BASED ON THE CONNECTICUT GEODETIC SURVEY STATE PLANE COORDINATES, NORTH AMERICAN DATUM OF 1983 - (NAD83).
 ELEVATIONS AND VERTICAL CONTROL IS BASED ON THE NORTH AMERICAN VERTICAL DATUM 1988 - (NAVD88).

THE LOCATION OF UNDERGROUND UTILITIES DEPICTED HEREON ARE BASED ON FIELD LOCATIONS AND BY INFORMATION PROVIDED BY OTHERS. THEIR TRUE LOCATIONS MAY VARY FROM THOSE INDICATED, AND ALL UNDERGROUND UTILITIES MAY NOT BE SHOWN. IF APPLICABLE, UTILIZE THE "CALL BEFORE YOU DIG" NUMBER (1-800-922-4455), TO VERIFY THE LOCATION OF ALL UNDERGROUND UTILITIES, AND RESOLVE CONFLICTS PRIOR TO STARTING CONSTRUCTION, REPAIR OR DESIGN.

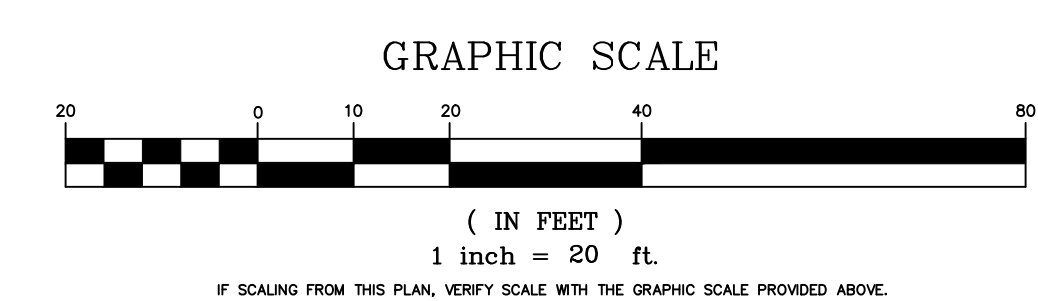

DRAWING ISSUE STATUS	
NO.	DESCRIPTION
1.	ISSUED FOR PERMITTING
NO.	DATE

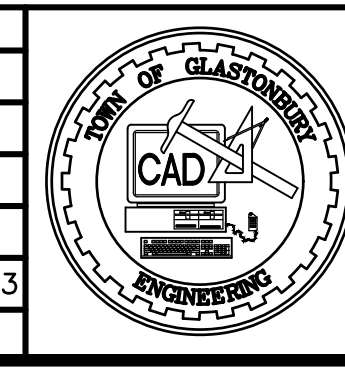

SCALE: AS SHOWN	DATE:
DRAWN BY: M.L.A.	05/11/2023
CHECKED BY: S.M.B.	05/11/2023
APPROVED BY: D.A.P.	05/11/2023
ST. FILE:	
DO NOT SCALE THIS DRAWING. USE THE DIMENSIONS GIVEN. IF THERE ARE ANY DISCREPANCIES OR QUESTIONS, CONTACT THE TOWN OF GLASTONBURY, ENGINEERING OFFICE.	

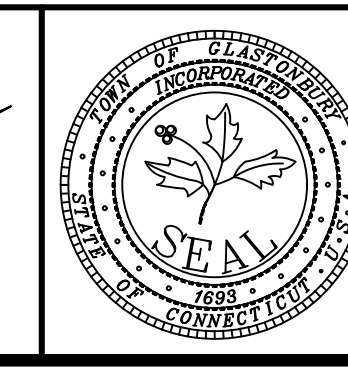

PRELIMINARY

SITE PLAN DEPICTING
 PROPOSED SIDEWALK IMPROVEMENTS
 LOCATED ON
 BELL STREET
 GLASTONBURY, CONNECTICUT

SHEET NO.
3
 OF 4

PW-2013

FILE: H:\DWG\Streets\Bell St\PW-2013 Bell Street Sidewalk Base Plan\BELL STREET SIDEWALK BASE PLAN - DESIGN.dwg USER: Macdonald-ansh DATE: 7/6/2023

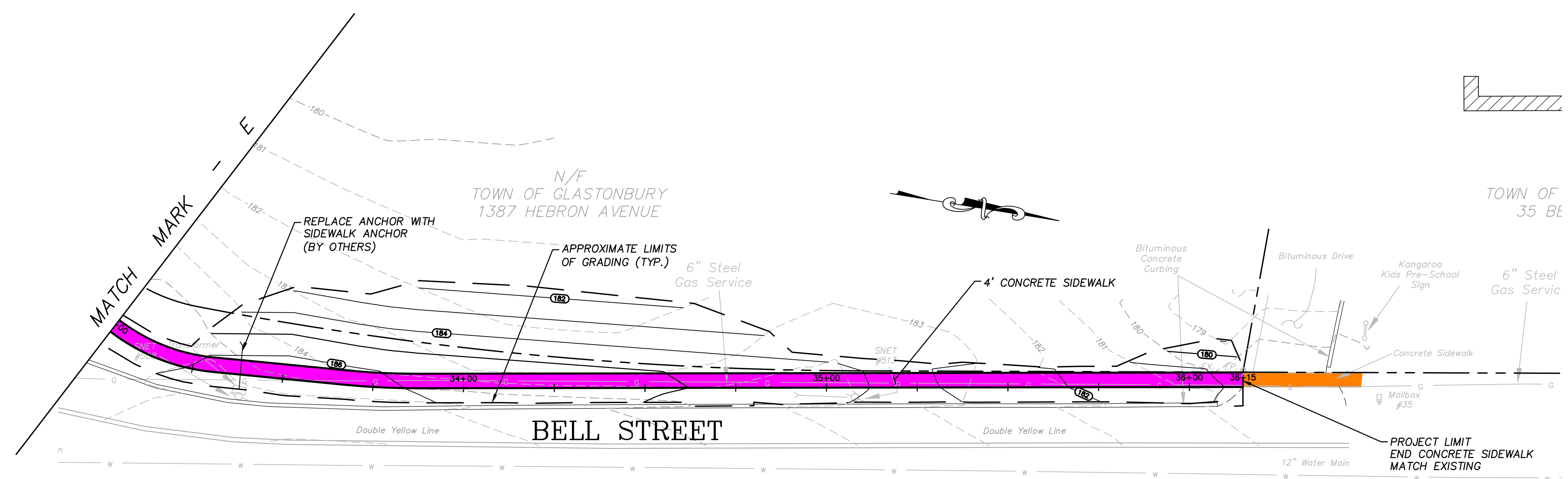
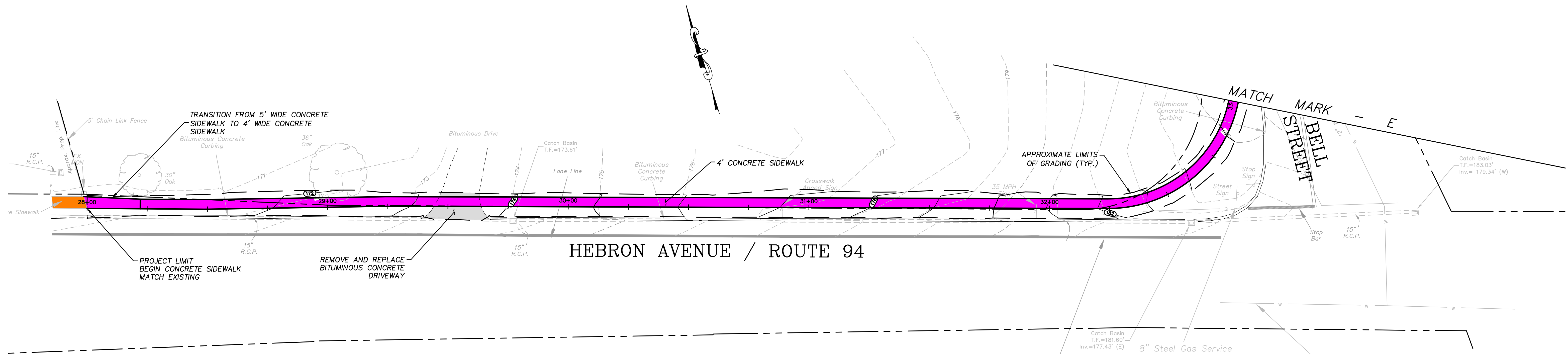

NOTE:
 LOCATION OF FEATURES AND CONTOUR DATA DEPICTED HEREON WERE ACQUIRED BY FIELD SURVEY ON JUNE 2019.
 THERE IS NO BOUNDARY/DETERMINATION OPINION.
 NO EASEMENTS PERTAINING TO THE SUBJECT PARCEL ARE DEPICTED HEREON.
 NOT ALL IMPROVEMENTS ARE DEPICTED HEREON.
 HORIZONTAL CONTROL IS BASED ON THE CONNECTICUT GEODETIC SURVEY STATE PLANE COORDINATES, NORTH AMERICAN DATUM OF 1983 - (NAD83).
 ELEVATIONS AND VERTICAL CONTROL IS BASED ON THE NORTH AMERICAN VERTICAL DATUM 1988 - (NAVD88).

THE LOCATION OF UNDERGROUND UTILITIES DEPICTED HEREON ARE BASED ON FIELD LOCATIONS AND BY INFORMATION PROVIDED BY OTHERS. THEIR TRUE LOCATIONS MAY VARY FROM THOSE INDICATED, AND ALL UNDERGROUND UTILITIES MAY NOT BE SHOWN. IF APPLICABLE, UTILIZE THE "CALL BEFORE YOU DIG" NUMBER (1-800-922-4455) TO VERIFY THE LOCATION OF ALL UNDERGROUND UTILITIES, AND RESOLVE CONFLICTS PRIOR TO STARTING CONSTRUCTION, REPAIR OR DESIGN.

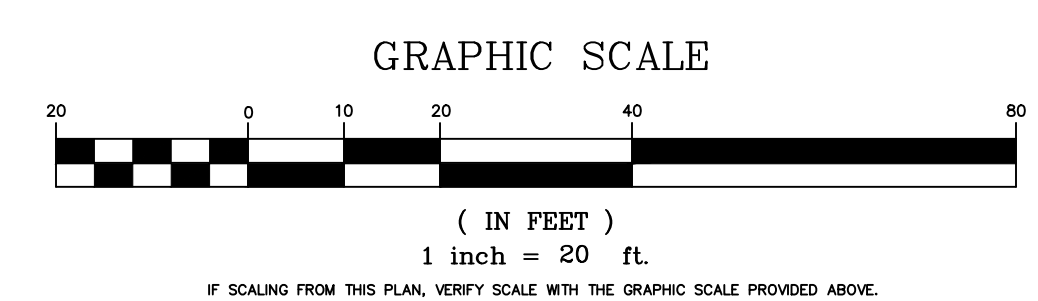

PW-2013

DRAWING ISSUE STATUS		
NO.	DESCRIPTION	DATE
1.	ISSUED FOR PERMITTING	05/11/2023

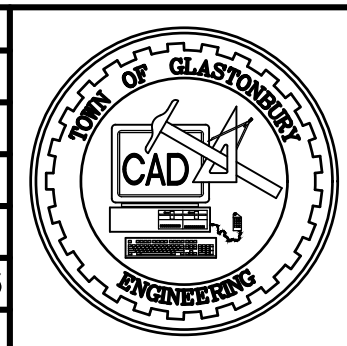

SCALE: AS SHOWN	DATE: 05/11/2023
DRAWN BY: M.L.A.	CHECKED BY: S.M.B.
APPROVED BY: D.A.P.	ST. FILE:

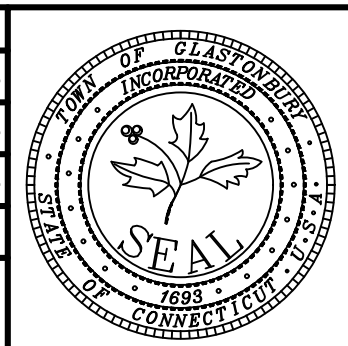

PRELIMINARY

SITE PLAN DEPICTING
 PROPOSED SIDEWALK IMPROVEMENTS
 LOCATED ON
 BELL STREET
 GLASTONBURY, CONNECTICUT

SHEET NO.
4
 OF 4