

PROJECT/APPLICANT	ZONE
PROJECT ADDRESS	
SPECIAL PERMIT SECTION	TPZ CHAIRMAN
DATE SPECIAL PERMIT APP'D	DIRECTOR OF COMMUNITY DEVELOPMENT
NOTE: ALL SHEETS OF THIS PLAN SET ARE LOCATED IN THE OFFICE OF COMMUNITY DEVELOPMENT FILE NO.	

PLANT LIST **2610 Main Street**

KEY	QTY	BOTANIC NAME COMMON NAME	SIZE	REMARKS
AC	3	Amelanchier canadensis SHADLOW SERVICEBERRY	6'-8"	MULTI-STEM
AGR	3	Acer griseum PAPERBARK MAPLE	2" CAL	SINGLE STEM MATCHED
ARO	6	Acer rubrum 'October Glory' OCTOBER GLORY RED MAPLE	2 1/2" CAL	
BMG	10	Buxus 'Green Velvet' GREEN VELVET BOXWOOD	24"	
CCA	2	Cercis canadensis EASTERN REDBUD	6'-8"	MULTI-STEM
CCF	1	Cercis canadensis 'Forest Pansy' PURPLE REDBUD	6'-8"	MULTI-STEM
CKF	30	Calamagrostis acutiflora 'Karl Foerster' KARL FOERSTER REED GRASS	2 GAL	
CRP	100	Coreopsis permathread 'Red Satin' RED SATIN COREOPSIS	2 GAL	
FSD	4	Fagus sylvatica 'Dawson Purple' DAWKSON PURPLE BEECH	3 1/2"	MATCHED
HEM-3	80	Hemerocallis species 'Woodside Fire Dance' WOODSIDE FIRE DANCE DAYLILY	2 GAL	
HOB	56	Heuchera micrantha 'Obsidian' OBSIDIAN CORAL BELLS	2 GAL	
HPL	10	Hydrangea paniculata 'Limelight' LIMELIGHT PANICLE HYDRANGEA	24"-30"	
HS-22	45	Hosta 'Patriot' PATRIOT HOSTA	1 GAL	2" O.C.
HS-7	32	Hosta fortunei 'Frances' FRANCEE HOSTA	1 GAL	
ISC	16	Iris sibirica 'Caesar's Brother' CAESAR'S BROTHER SIBERIAN IRIS	2 GAL	
NS	1	Nyssa sylvatica 'Wild Fire' WILD FIRE SOUR GUM	2 1/2"	
PAB	2	Picea abies NORWAY SPRUCE	6'-8"	
PAD	24	Pennisetum alopecuroides 'Hamelin' DWARF FOUNTAIN GRASS	1 GAL	30" O.C.
PFJ	8	Potentilla fruticosa 'Jackman' JACKMAN'S POTENTILLA	18"-24"	
PJM	6	Rhododendron 'P.J.M.' P.J.M. RHODODENDRON	24"	
PPG	1	Picea pungens 'Glauca' COLORADO BLUE SPRUCE	7"	
QRF	3	Quercus rubrum 'Fastigiata' COLUMNAR ENGLISH OAK	3 1/2" CAL	MATCHED
SBG	14	Spiraea x bumalda 'Goldflame' GOLDFLAME SPIREA	18"-24"	
TCG	3	Tsuga canadensis 'Geneva' GENEVA HEMLOCK	6'-7"	UNSHEARED
TMD	36	Taxus x media densiformis DENSE YEW	24"	
TOT	22	Thuja occidentalis 'Tachyn' MISSION STRAIN ARBORVITAE	6"	
VDJ	3	Viburnum dentatum 'Autumn Jazz' AUTUMN JAZZ VIBURNUM	5"	
VPR	5	Viburnum prunifolium BLACK HAW VIBURNUM	5'-6"	
WTE	350	Waldsteinia ternata BARREN STRAWBERRY	2" PLUGS	12" O.C.

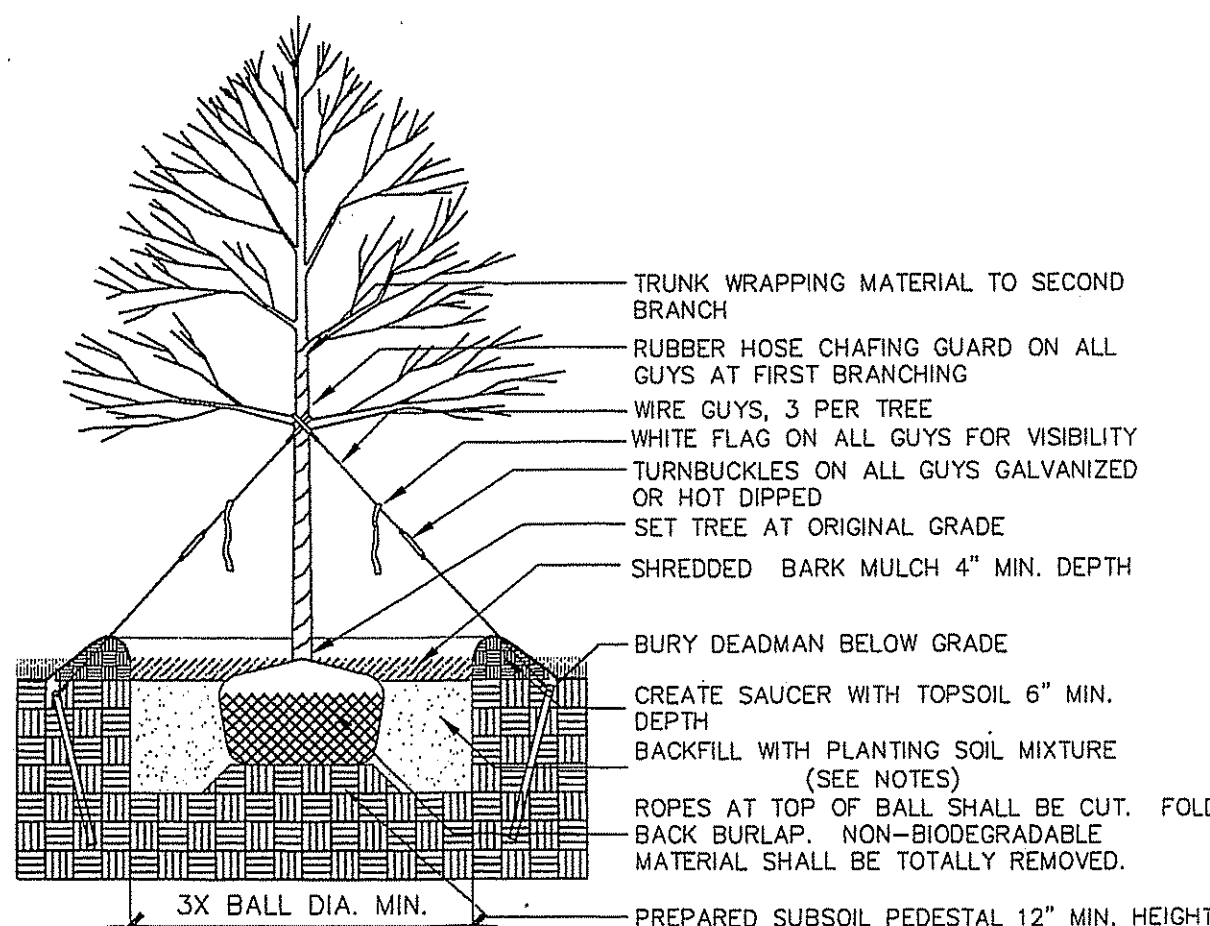

DECIDUOUS TREE PLANTING

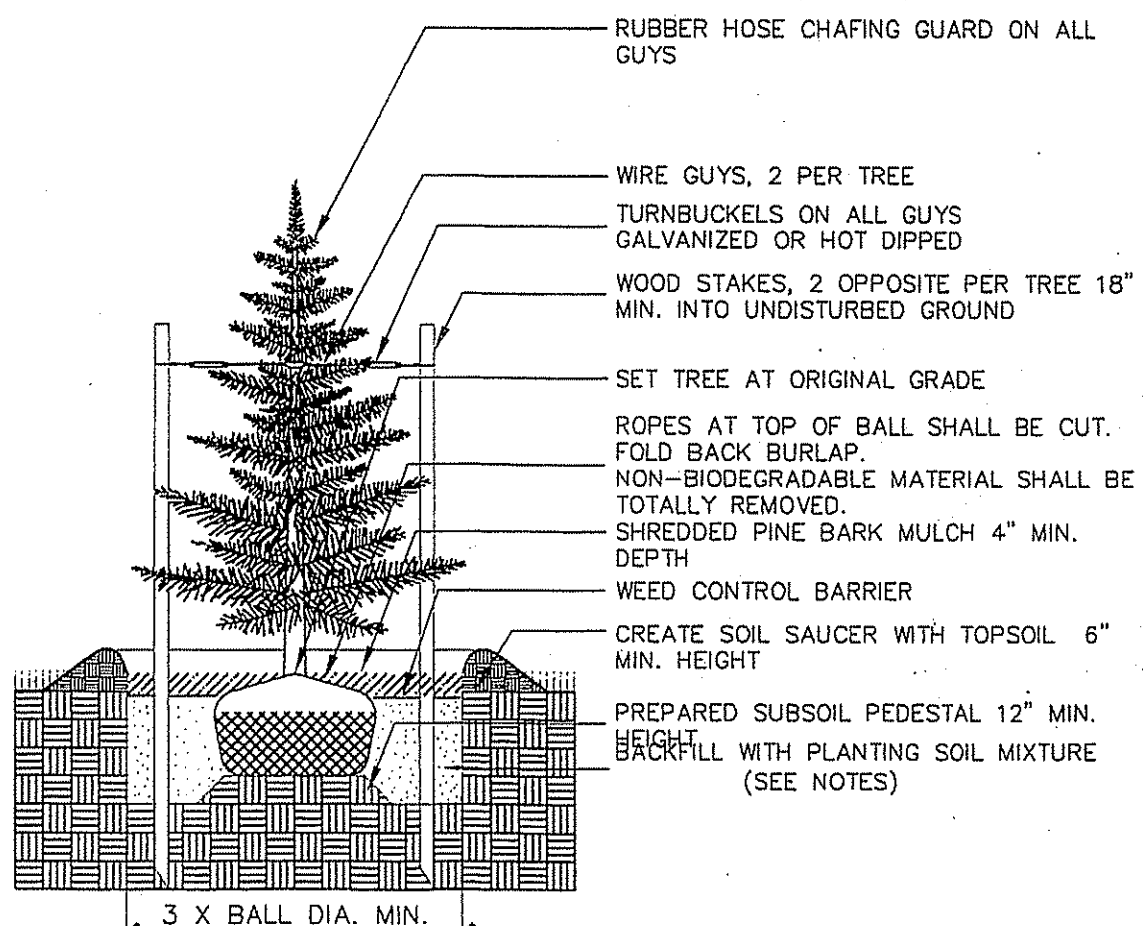

CONIFEROUS TREE PLANTING

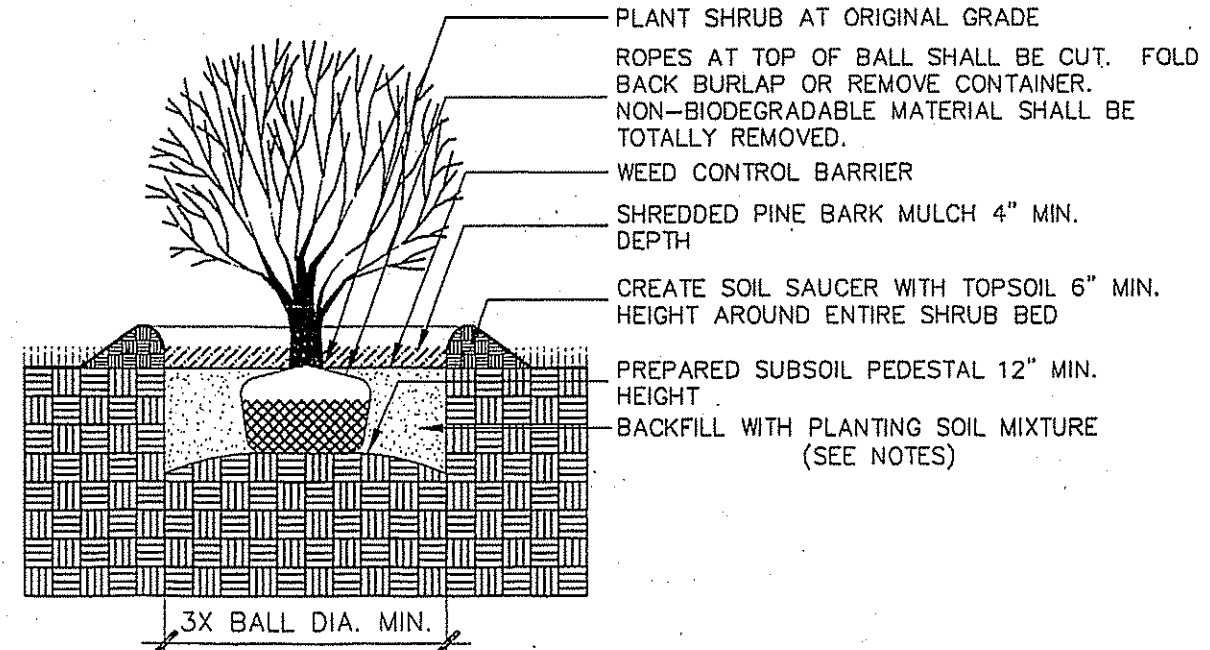

SHRUB PLANTING

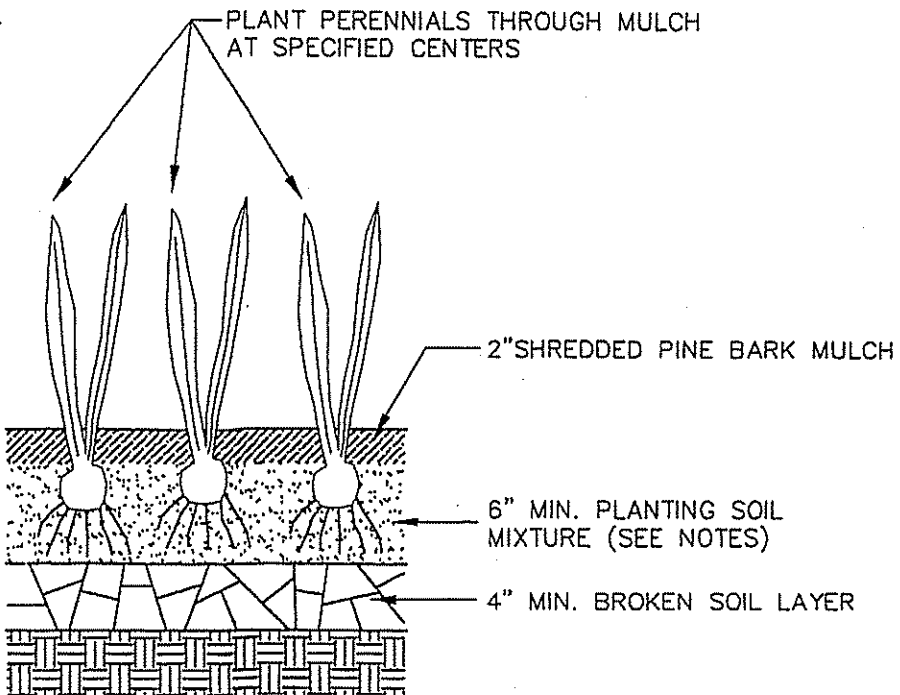

PERENNIAL PLANTING

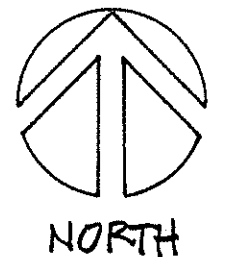
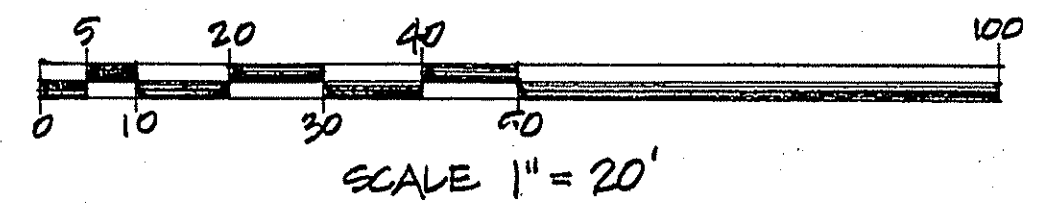
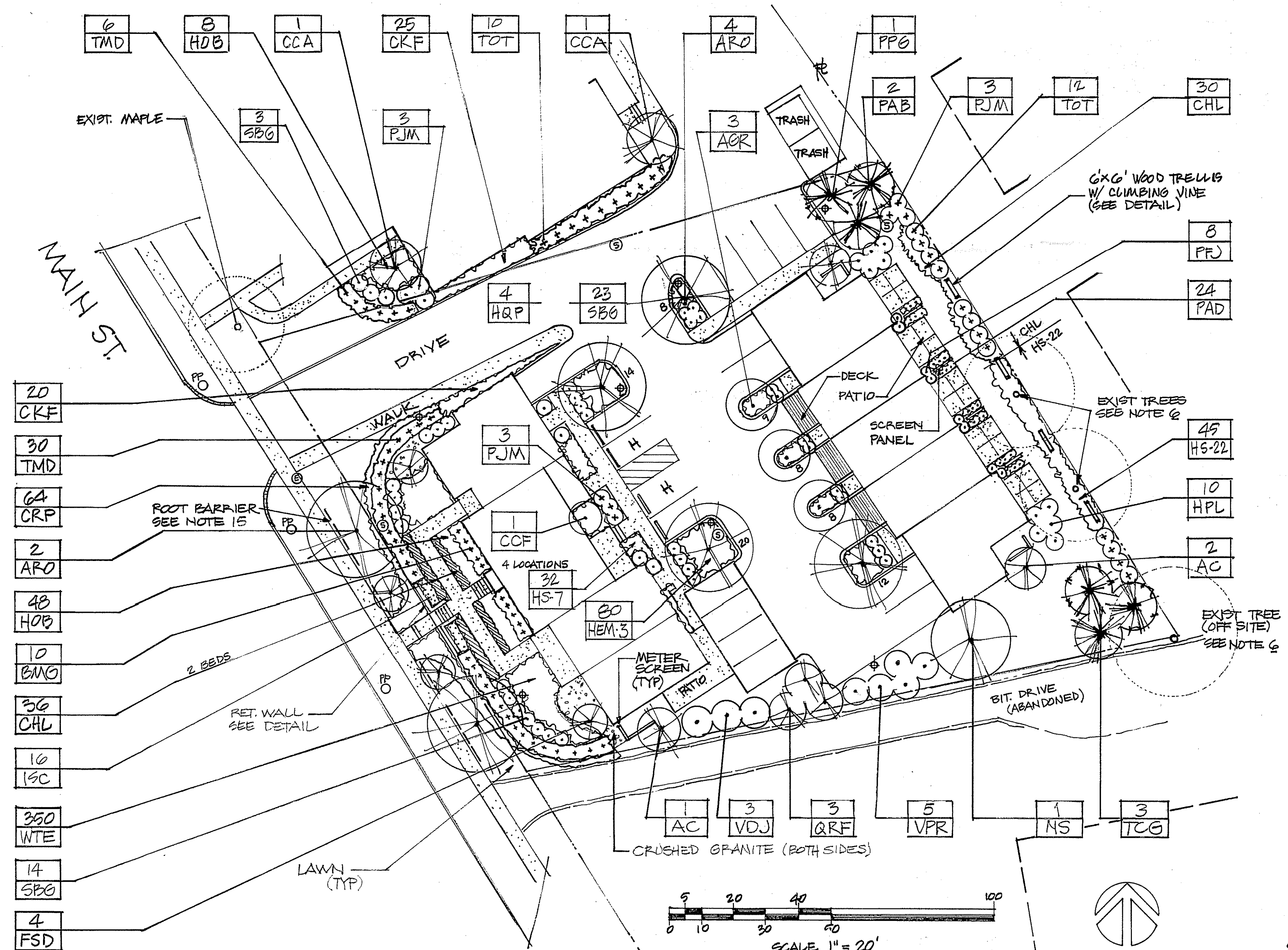

OWNER:
JOE JACONETTA
2690 MAIN ST.
GLASTONBURY, CT 06033

PLANTING NOTES **2610 Main Street**

- All plant materials shall conform to the guidelines established by the American Nursery & Landscape Association.
- All disturbed areas not covered by buildings, or planting shall be sodded lawn. New lawn areas shall receive a minimum of 6" topsoil of the proper pH and organic content suitable for the healthy growth of lawns. Contractor will be responsible for mowing and watering during the guarantee period. Lawn areas shall be guaranteed for 60 days or second cutting, whichever is later.
- Contractor shall set plants out in field for approval of locations by Landscape Architect prior to planting.
- Spade edge all planting beds within lawn areas. Provide clean spaded edge at perimeter of all planting beds and tree pits adjacent to lawn areas. Spade edge of newly planted lawn areas following second mowing.
- All planting beds and pits to receive approved mulch to depths indicated in planting details.
- Where discrepancies occur between planting quantities or types shown on plan and in the Plant List, the quantity of plantings shown on plan shall prevail.
- Landscape Contractor shall guarantee all plant material for one (1) full year from date of acceptance. Proper landscape maintenance shall be the responsibility of the owner.
- Shade trees shall have a branching height of five (5') minimum.
- All tree and shrub pits shall be at least 2 feet wider and 2 feet deeper than the tree or shrub root ball to be planted in it. Backfill shall be high quality loam of the proper pH and organic content suitable for the healthy plant growth of plant materials.
- All areas to be mulched shall receive 4 inches minimum 100% shredded bark mulch within 48 hours of planting unless otherwise noted in planting details.
- Plants shall be handled at all times in accordance with the best horticultural practices. Plants in-leaf shall be sprayed with anti-desiccant before digging. Plants shall be dug with firm natural balls and shall conform to the ratios and sizes specified in ANSI Z60.1. B&B plants shall be wrapped in burlap and tied firmly. Plant materials shall be delivered immediately prior to placement, shall be kept moist, and shall be protected from sun and wind. Plants having broken or cracked balls prior to or during planting will not be accepted.
- All trunks of deciduous trees shall be wrapped immediately after planting with tree wrap. Wrap shall be wound spirally, from the bottom of the trunk to the second branches. All trees in windy areas shall be staked or guyed immediately after planting.
- The period for planting shall be from March 15 to May 15 and from September 15 to November 15, weather permitting.
- All locations of existing utilities may not be shown on this plan. See other plan sheets for utility locations. Contractor shall be solely responsible for determining actual locations of existing utilities. Utility conflicts may require adjustments to proposed construction. Contractor shall be responsible for repair of any utilities damaged during construction. Contact call before you dig 1-800-922-4455 www.cbvd.com at least two (2) working days before starting construction to locate utilities.
- Install NDS root barrier SM-3620 - 36"x20" per manufacturer's instructions, centered at 4 locations between sidewalk and property line (see plan).

HEREBY DECLARE TO THE BEST OF MY KNOWLEDGE AND BELIEF THAT THIS PLAN IS SUBSTANTIALLY CORRECT.

Thomas Gracetta Landscape Architect, LLC
19 Flag Drive Manchester, Connecticut 06042
815-742-1930
thomasgracetta@gmail.com

PLANTING PLAN
2610 MAIN STREET
PREPARED FOR
JAYS and TEE, LLC
GLASTONBURY, CT

REVISED

DATE 8/26/2022

SHEET