

REV.	DATE	REVISION DESCRIPTION

PUBLIC INFORMATION MEETING

DESIGNER/DRAFTER: CAC/JLD

CHECKED BY: SDG

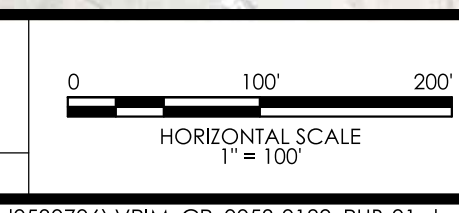

SIGNATURE/BLOCK:

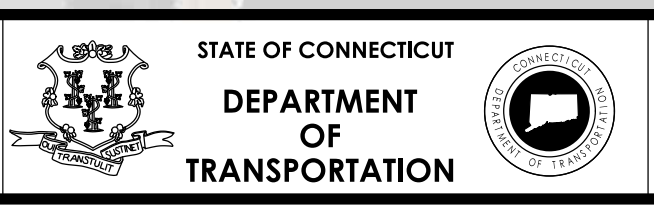

PROJECT NUMBER: 0053-0189

PROJECT DESCRIPTION: REMOVAL OF BRIDGE NOS. 00388 AND 00389 AND ROUTE 17 SB OFF-RAMP 007

TOWN(S): GLASTONBURY

DRAWING TITLE: ROUTE 17 NB LANE CONFIGURATION

DRAWING NO. PUB-01

SHEET NO.

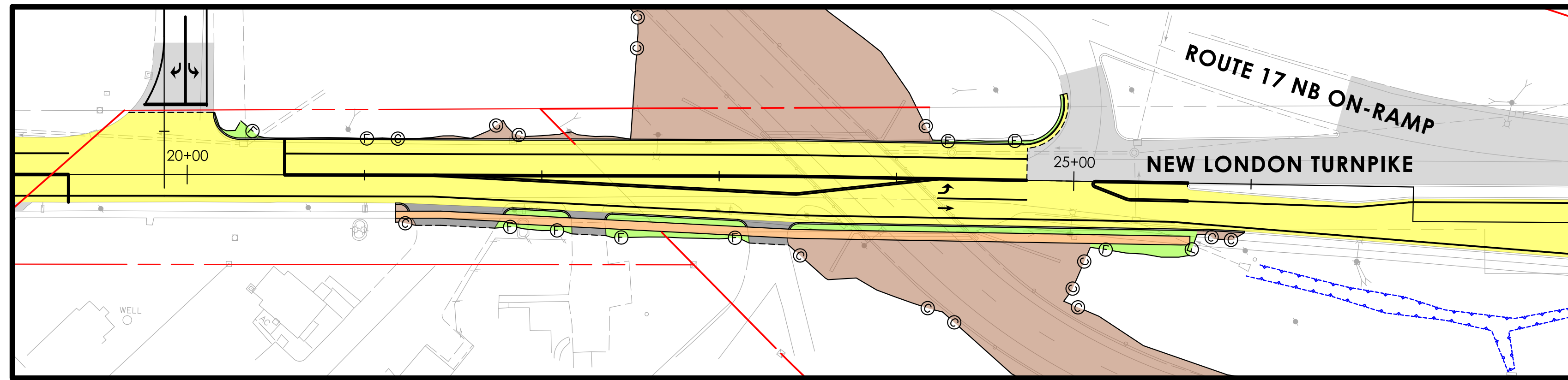
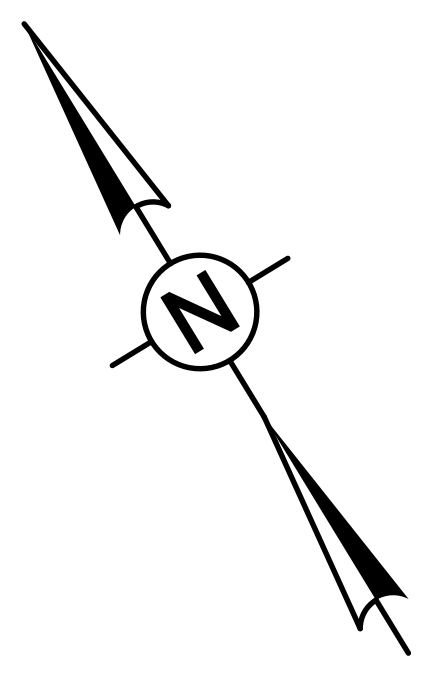

INSET 'A'

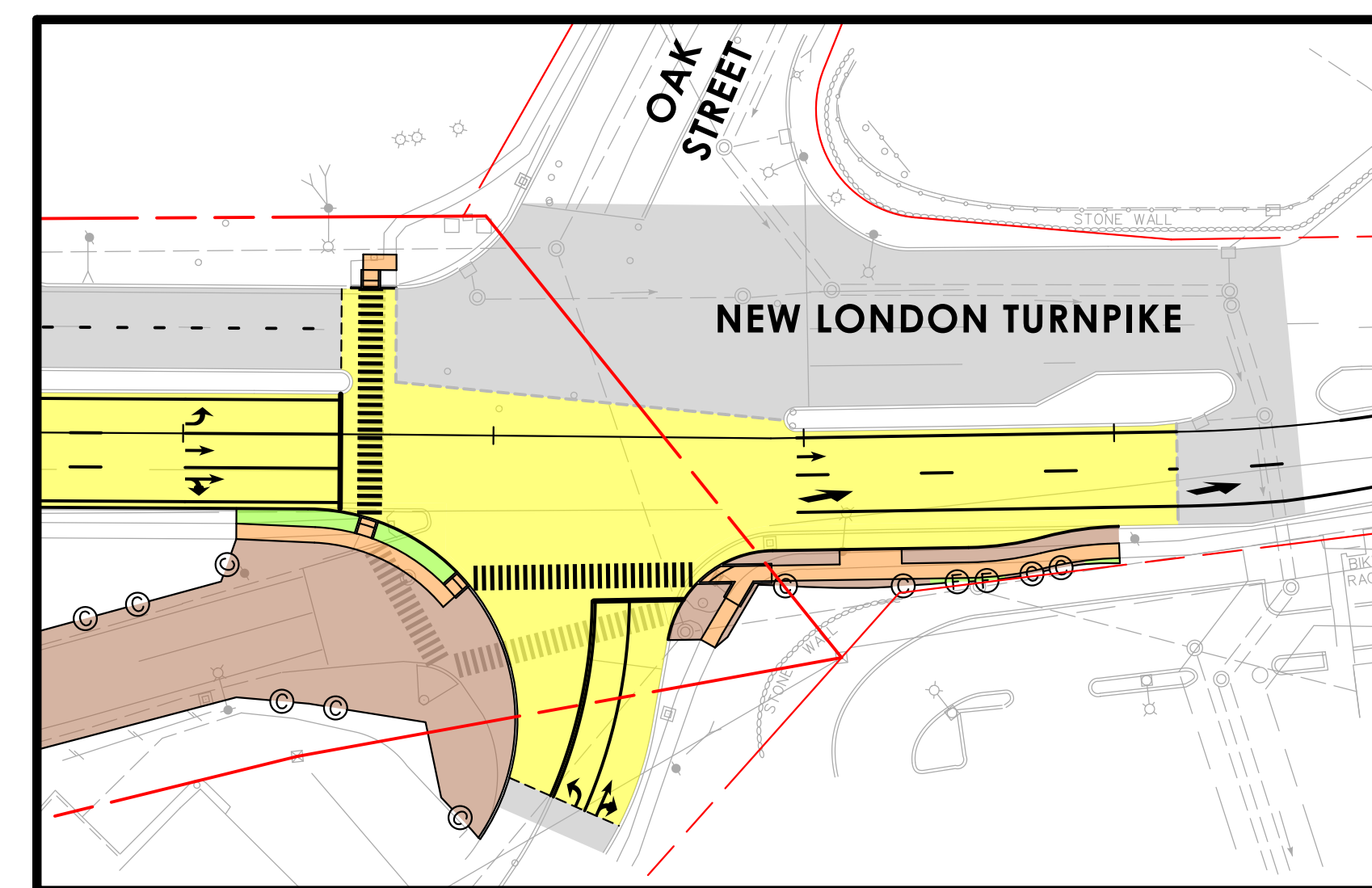

INSET 'B'

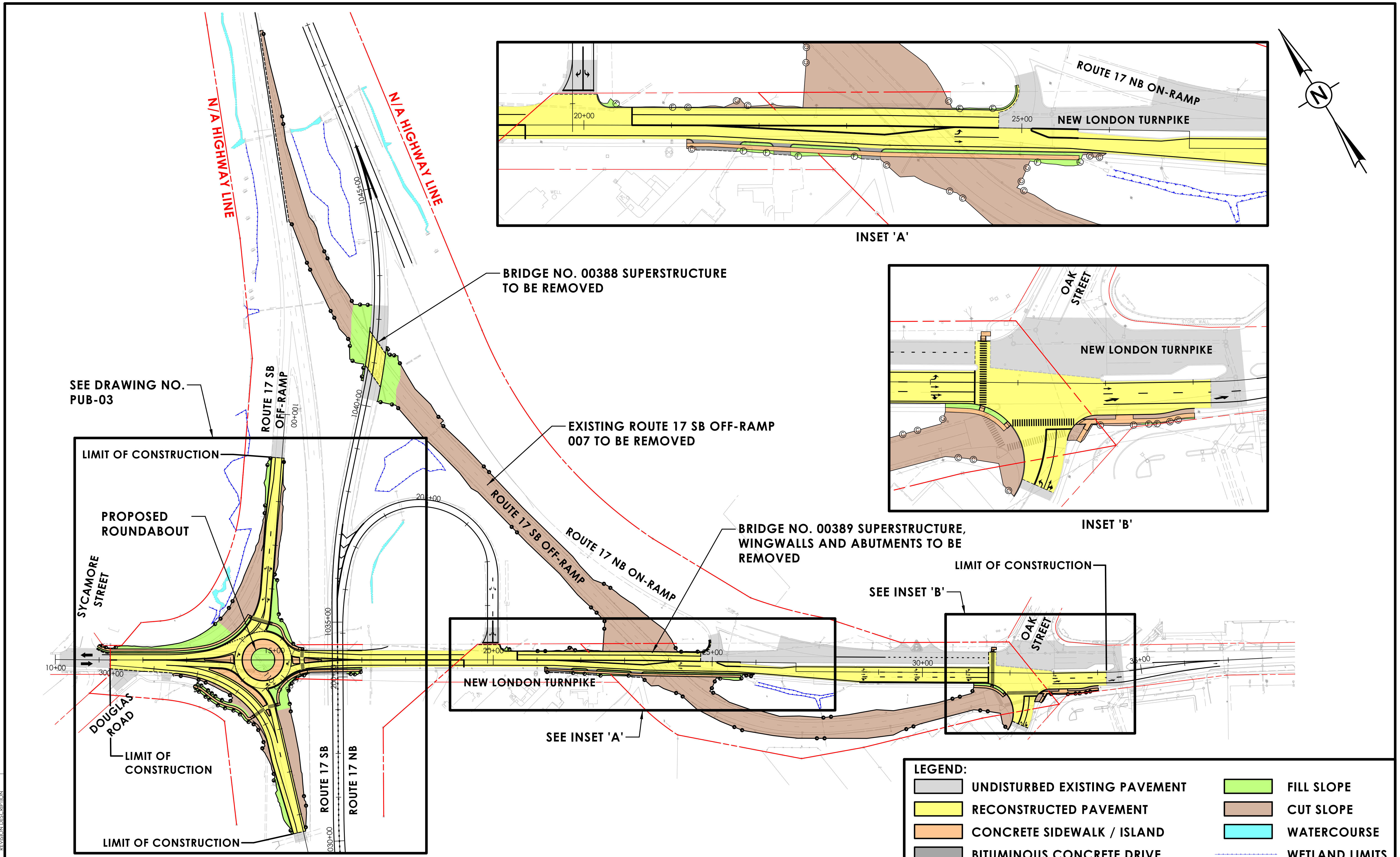

SEE DRAWING NO. PUB-03

BRIDGE NO. 00388 SUPERSTRUCTURE TO BE REMOVED

EXISTING ROUTE 17 SB OFF-RAMP 007 TO BE REMOVED

BRIDGE NO. 00389 SUPERSTRUCTURE, WINGWALLS AND ABUTMENTS TO BE REMOVED

SEE INSET 'A'

SEE INSET 'B'

LEGEND:			
	UNDISTURBED EXISTING PAVEMENT		FILL SLOPE
	RECONSTRUCTED PAVEMENT		CUT SLOPE
	CONCRETE SIDEWALK / ISLAND		WATERCOURSE
	BITUMINOUS CONCRETE DRIVE		WETLAND LIMITS

REV.	DATE	REVISION DESCRIPTION

PRELIMINARY DESIGN REVIEW

SCALE AS NOTED

SIGNATURE/BLOCK: WSP USA, INC. 500 WINDING BROOK DR GLASTONBURY, CT 06033

STATE OF CONNECTICUT DEPARTMENT OF TRANSPORTATION

PROJECT NUMBER: 0053-0189
 PROJECT DESCRIPTION: REMOVAL OF BRIDGE NOS. 00388 AND 00389 AND ROUTE 17 SB OFF-RAMP 007
 TOWN(S): GLASTONBURY
 DRAWING TITLE: OVERALL PROJECT PLAN

DRAWING NO. PUB-02
 SHEET NO.

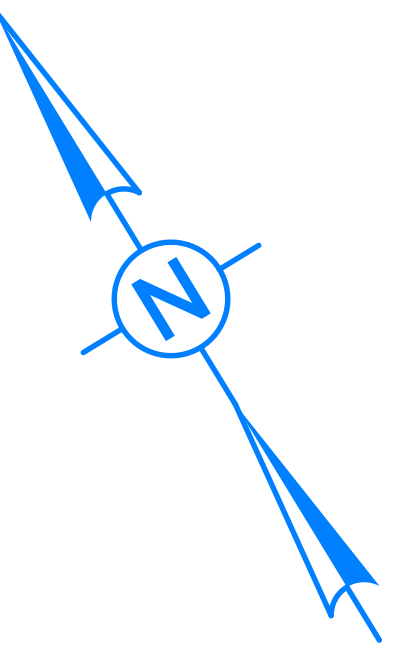

BEGIN FULL DEPTH PAVEMENT RECONSTRUCTION
ROUTE 17 SB OFF-RAMP STA 101+00

LANDSCAPED CENTER ISLAND
(54' DIAMETER)
18' CIRCULATORY ROADWAY
20' STAMPED CONCRETE TRUCK APRON

END FULL DEPTH PAVEMENT RECONSTRUCTION
BEGIN MILL AND OVERLAY
NEW LONDON TURNPIKE STA. 17+00

SYCAMORE STREET

NEW LONDON TURNPIKE

DOUGLAS ROAD

BEGIN FULL DEPTH PAVEMENT
RECONSTRUCTION
NEW LONDON TURNPIKE
STA 11+25
12' BYPASS LANE

N/A HIGHWAY LINE









ROUTE 17 SB

ROUTE 17 NB

N/A HIGHWAY LINE

END FULL DEPTH PAVEMENT RECONSTRUCTION
ROUTE 17 SB ON-RAMP STA 113+40

LEGEND:

-  UNDISTURBED EXISTING PAVEMENT
-  RECONSTRUCTED PAVEMENT
-  CONCRETE SIDEWALK / ISLAND
-  BITUMINOUS CONCRETE DRIVE
-  FILL SLOPE
-  CUT SLOPE
-  WATERCOURSE
-  WETLAND LIMITS

REV.	DATE	REVISION DESCRIPTION

PUBLIC INFORMATION MEETING

DESIGNER/DRAFTER: CAC/JLD CHECKED BY: SDG

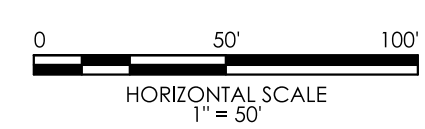

SIGNATURE/BLOCK: 

WSP USA, INC.
500 WINDING BROOK DR
GLASTONBURY, CT 06033

APPROVED BY: _____

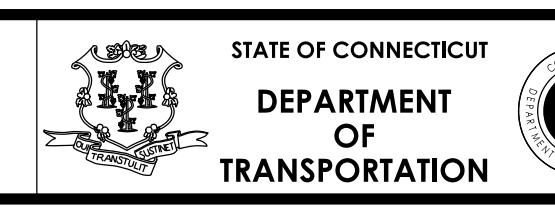

PROJECT NUMBER: 0053-0189
PROJECT DESCRIPTION: REMOVAL OF BRIDGE NOS. 00388 AND 00389 AND ROUTE 17 SB OFF-RAMP 007
TOWN(S): GLASTONBURY
DRAWING TITLE: ROUNDABOUT PLAN

DRAWING NO. PUB-03
SHEET NO.

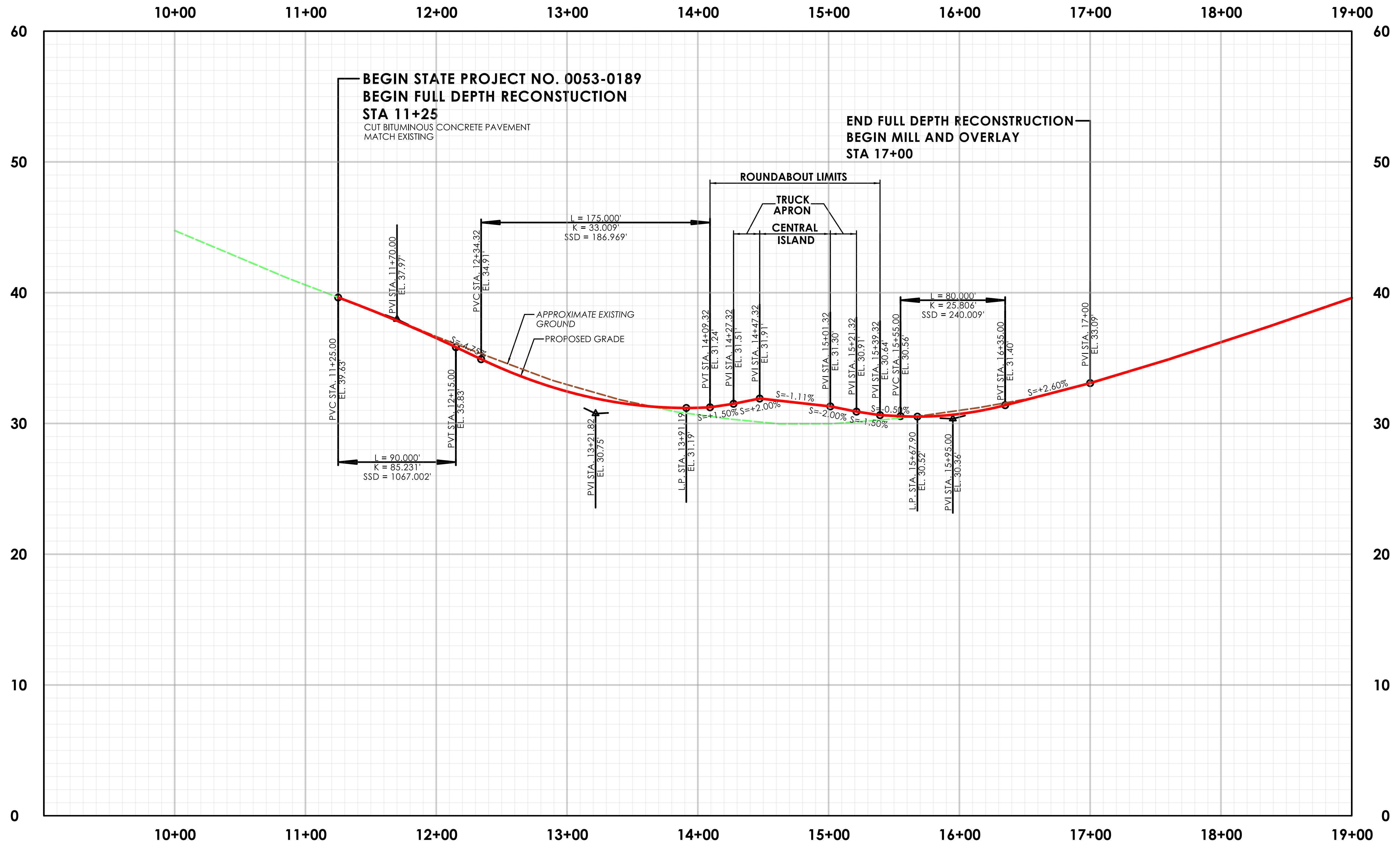

REV.	DATE	REVISION DESCRIPTION

PUBLIC INFORMATION MEETING

DESIGNER/DRAFTER: CAC/JLD CHECKED BY: SDG

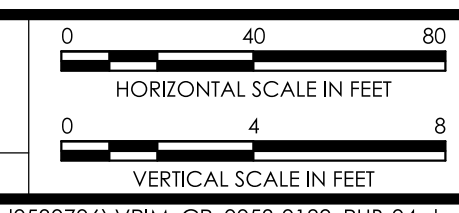

SIGNATURE/BLOCK: **WSP**
 WSP USA, INC.
 500 WINDING BROOK DR
 GLASTONBURY, CT 06033

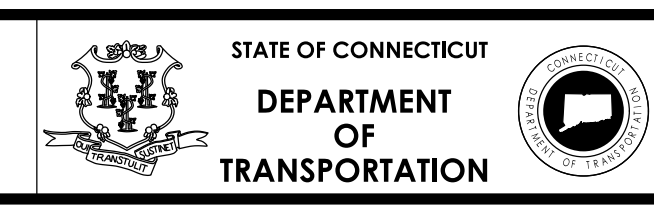

PROJECT NUMBER: 0053-0189
 PROJECT DESCRIPTION: REMOVAL OF BRIDGE NOS. 00388 AND 00389 AND ROUTE 17 SB OFF-RAMP 007
 TOWN(S): GLASTONBURY
 DRAWING TITLE: NEW LONDON TURNPIKE PROFILE

DRAWING NO. PUB-04
 SHEET NO.

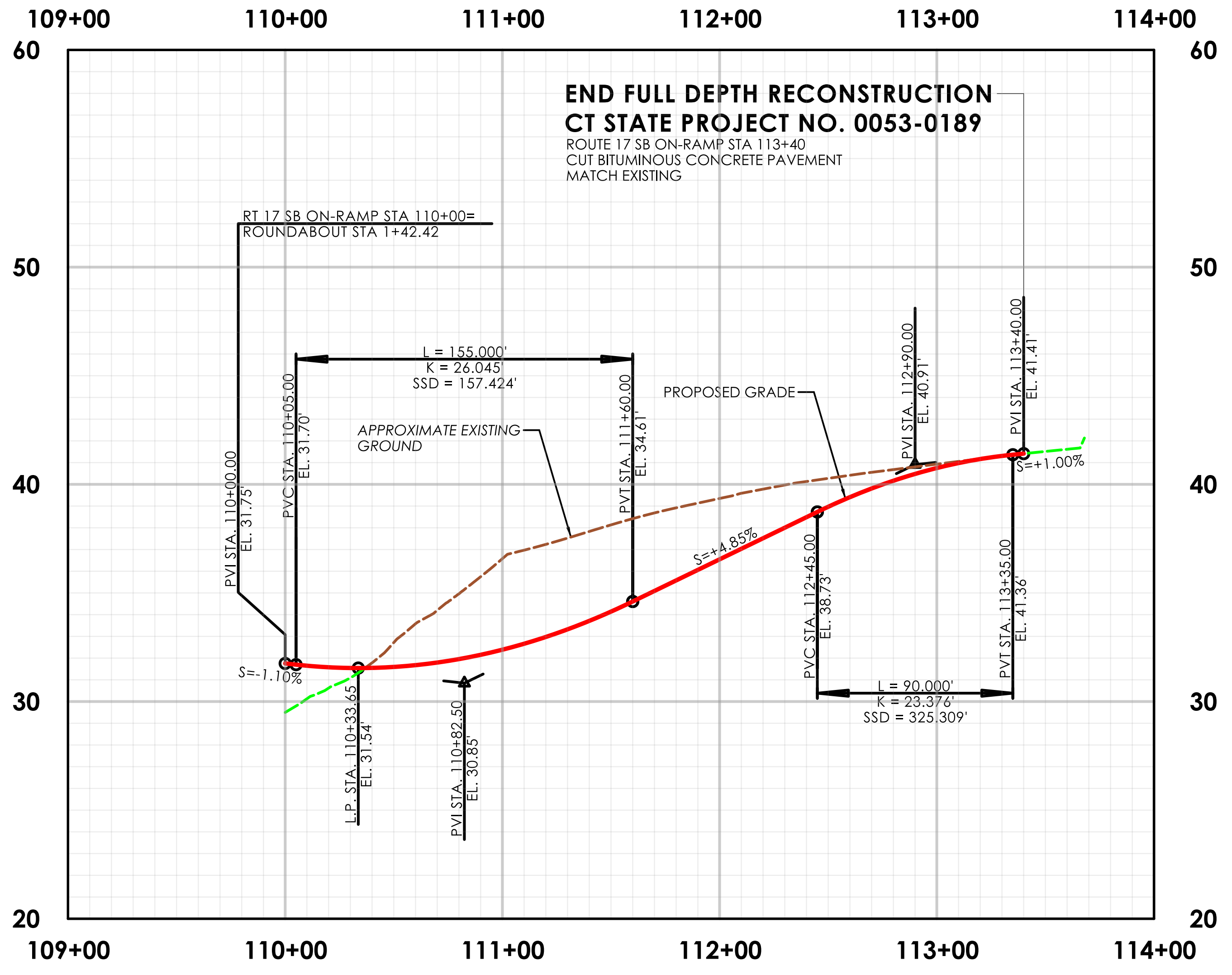

REV.	DATE	REVISION DESCRIPTION

PUBLIC INFORMATION MEETING

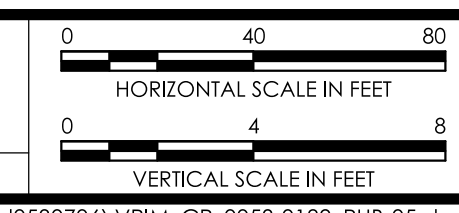

SIGNATURE/BLOCK:  WSP
 WSP USA, INC.
 500 WINDING BROOK DR
 GLASTONBURY, CT 06033

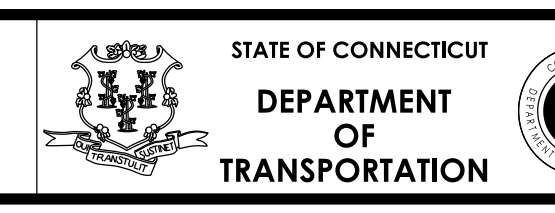

PROJECT NUMBER: 0053-0189
 PROJECT DESCRIPTION: REMOVAL OF BRIDGE NOS. 00388 AND 00389 AND ROUTE 17 SB OFF-RAMP 007
 TOWN(S): GLASTONBURY
 DRAWING TITLE: ROUTE 17 SB ON-RAMP PROFILE

DRAWING NO. PUB-05
 SHEET NO.

LEGEND:

- RECONSTRUCTED PAVEMENT SECTION
- CONCRETE SIDEWALK/ISLAND/APRON
- FILL SLOPE
- CUT SLOPE

- (A) 4" PMA S0.5 TRAFFIC LEVEL 2
- (B) 6" HMA S1.0 TRAFFIC LEVEL 2
- (C) NOT USED
- (D) NOT USED
- (E) 12" SUBBASE
- (F) 6" TOPSOIL AND TURF ESTABLISHMENT
- (G) GRANITE CURB
- (H) SPECIAL GRANITE CURB
- (I) NOT USED
- (J) 5" CONCRETE SIDEWALK ON 8" GRANULAR FILL
- (K) NOT USED
- (L) NOT USED
- (M) 12" STAMPED CONCRETE
- (N) 8" CONCRETE ON 8" GRANULAR FILL
- (O) BITUMINOUS CONCRETE SIDEWALK
- (P) 10" PROCESSED AGGREGATE BASE
- ↑ DIRECTION OF TRAVEL AHEAD STATION
- ↓ DIRECTION OF TRAVEL BACK STATION

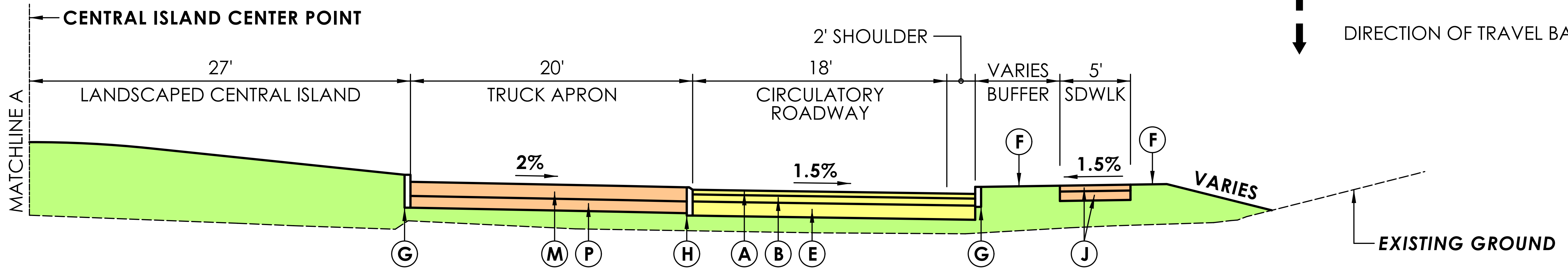
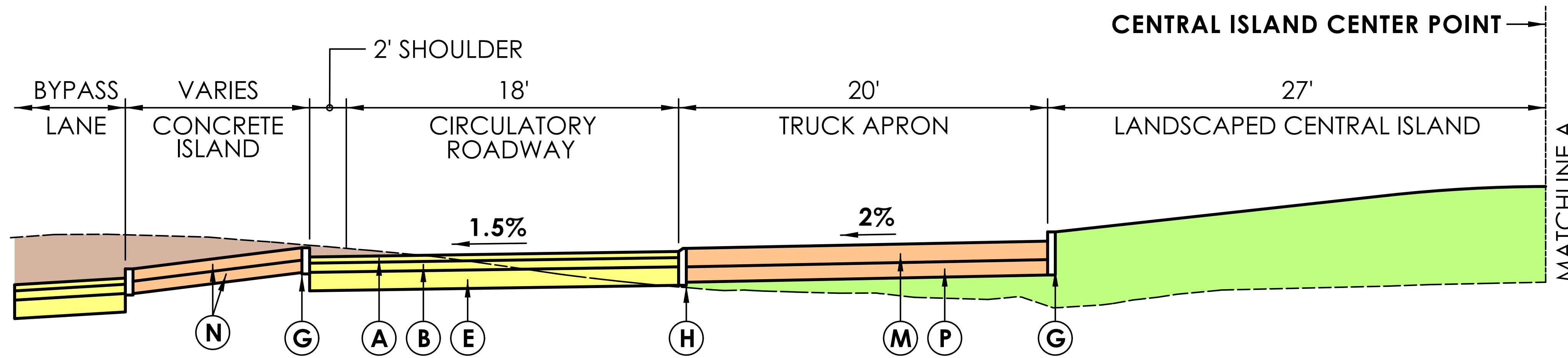

NEW LONDON TURNPIKE ROUNDABOUT

REV.	DATE	REVISION DESCRIPTION

PUBLIC INFORMATION MEETING
 DESIGNER/DRAFTER: CAC/JLD
 CHECKED BY: SDG

NOT TO SCALE

SIGNATURE/BLOCK:

 WSP USA, INC.
 500 WINDING BROOK DR
 GLASTONBURY, CT 06033

STATE OF CONNECTICUT
 DEPARTMENT OF TRANSPORTATION

PROJECT NUMBER: 0053-0189
 PROJECT DESCRIPTION: REMOVAL OF BRIDGE NOS. 00388 AND 00389 AND ROUTE 17 SB OFF-RAMP 007
 TOWN(S): GLASTONBURY
 DRAWING TITLE: TYPICAL SECTIONS - 1

DRAWING NO.: PUB-06
 SHEET NO.:

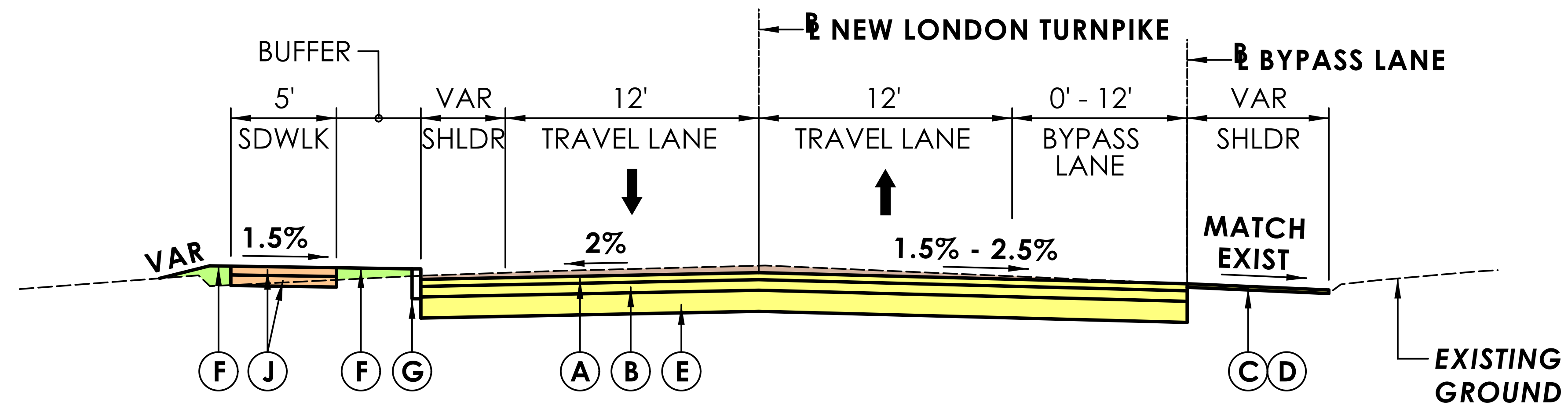

NEW LONDON TURNPIKE (TYPICAL FULL DEPTH RECONSTRUCTION)

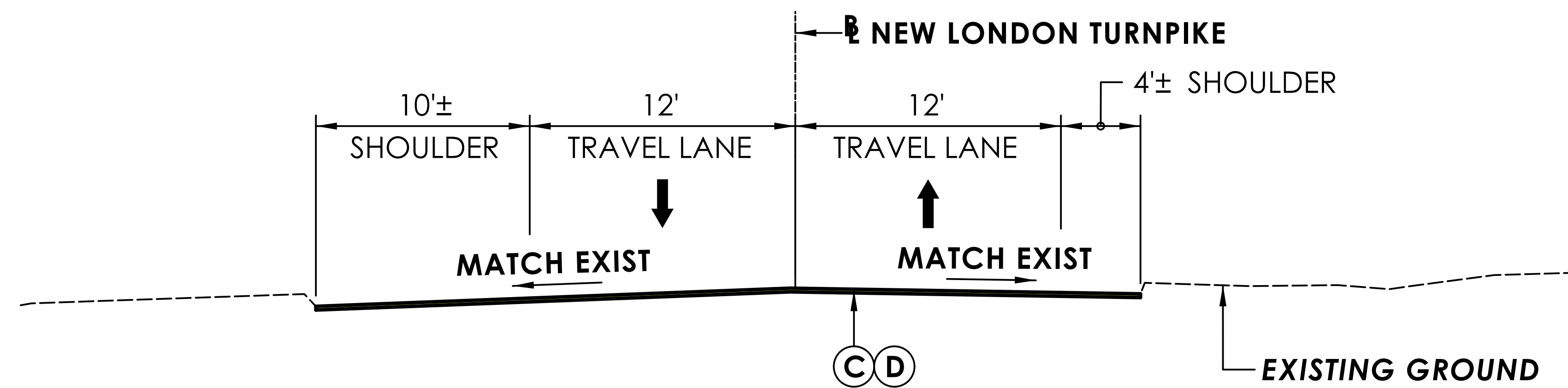

NEW LONDON TURNPIKE (TYPICAL MILL AND OVERLAY)

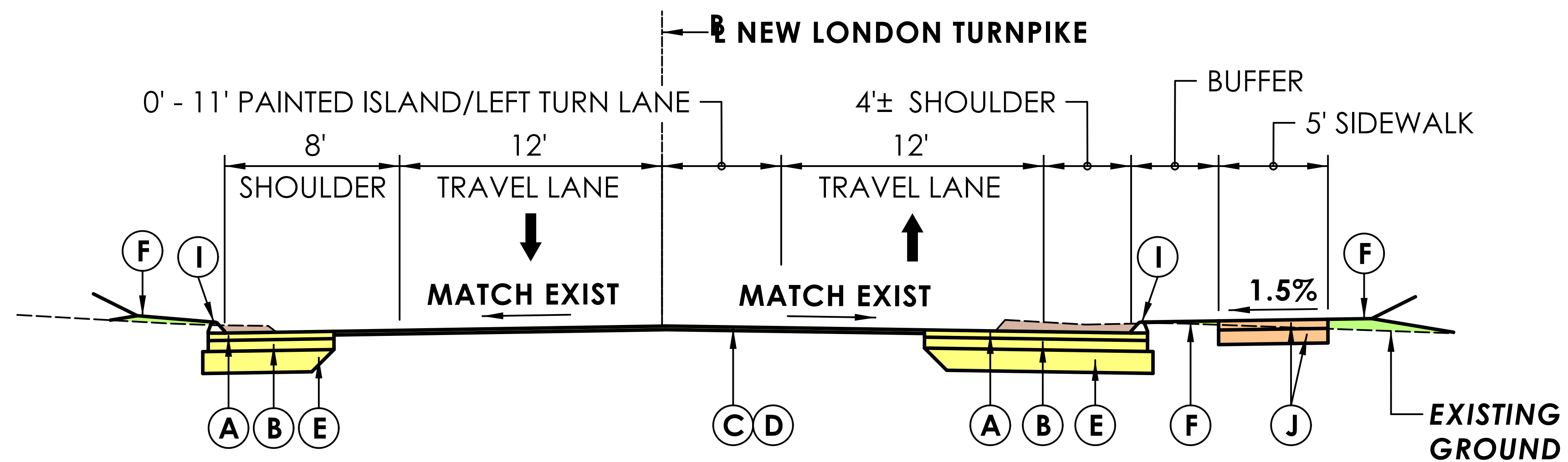

NEW LONDON TURNPIKE (TYPICAL WIDENING)

LEGEND:

- (A) 4" PMA S0.5 TRAFFIC LEVEL 2
- (B) 6" HMA S1.0 TRAFFIC LEVEL 2
- (C) 2" PMA S0.5 TRAFFIC LEVEL 2
- (D) 2" FINE MILLING
- (E) 12" SUBBASE
- (F) 6" TOPSOIL AND TURF ESTABLISHMENT
- (G) GRANITE CURB
- (H) NOT USED
- (I) BITUMINOUS CONCRETE LIP CURB
- (J) 5" CONCRETE SIDEWALK ON 8" GRANULAR FILL

- ↑ DIRECTION OF TRAVEL AHEAD STATION
- ↓ DIRECTION OF TRAVEL BACK STATION

- RECONSTRUCTED PAVEMENT SECTION
- CONCRETE SIDEWALK
- FILL SLOPE
- CUT SLOPE

REV.	DATE	REVISION DESCRIPTION

PUBLIC INFORMATION MEETING
 NOT TO SCALE
 DESIGNER/DRAFTER: CAC/JLD
 CHECKED BY: SDG

SIGNATURE/
 BLOCK:



STATE OF CONNECTICUT
 DEPARTMENT OF
 TRANSPORTATION

PROJECT NUMBER: 0053-0189
 PROJECT DESCRIPTION: REMOVAL OF BRIDGE NOS. 00388 AND 00389 AND ROUTE 17 SB OFF-RAMP 007
 TOWN(S): GLASTONBURY
 DRAWING TITLE: TYPICAL SECTIONS - 2

DRAWING NO.
 PUB-07
 SHEET NO.