

Lot numbers refer to map titled:  
 "Topographic Map prepared for  
 Frank Fink & Sons, Scale 1"=100'  
 Dated 7-15-67 by Mozzochi  
 & Hoppa, Civil Engineers.

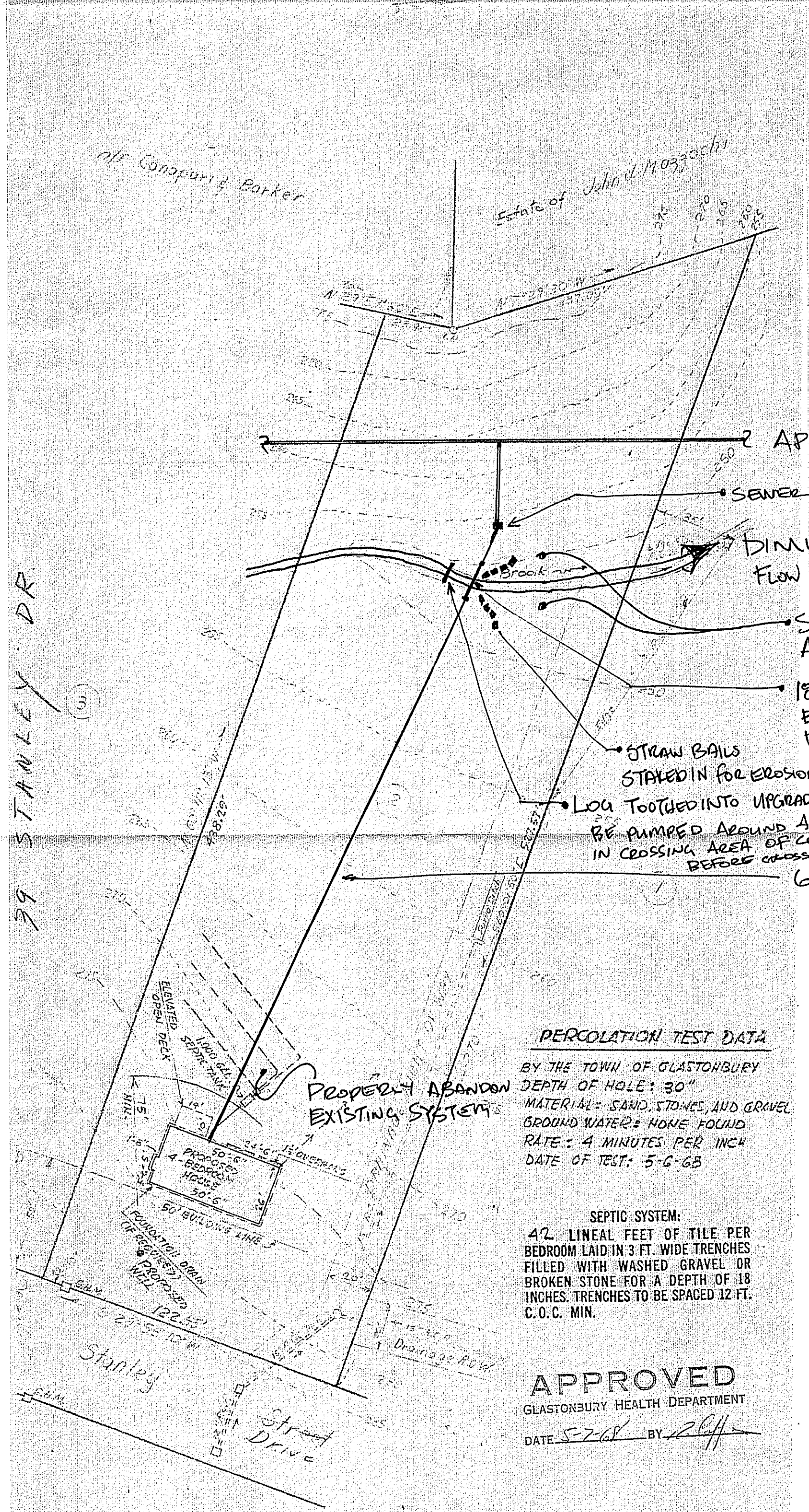

- APPROXIMATE TOWN SEWER
- SEWER LATERAL CONNECTION POINT 6'-5" DEPTH
- DIMINISHING FLOW BROOK 3 FEET IN WIDTH ON MAY 1 WHEN INSPECTED  
 FLOW EXPECTED TO BE LESS AT TIME OF CONSTRUCTION
- SOILS ON EITHER SIDE OF BROOK  
 ARE FIRM AND VEGETATED; NO MARSHY AREAS.
- 18' LENGTH OF 6" DUCTILE IRON THROUGH BROOK W/ SHEER-  
 BANDED FERNCO COUPLERS TO PREVENT WASHOUT -  
 DEPTH UNDER BROOK +/- 3 FEET
- STRAW BALS  
 STAPLED IN FOR EROSION CONTROL TO REMAIN UNTIL VEGETATION RE-ESTABLISHES
- LOG TIGHTENED INTO UPGRADIENT BANK TO CREATE A TEMPORARY DAM AND ALLOW WATER TO  
 BE PUMPED AROUND AREA OF CONCERN; TRENCH FROM BROOK TO LATERAL TO BE BACKFILLED  
 IN CROSSING AREA OF CONCERN; TRENCH FROM BROOK TO LATERAL TO BE BACKFILLED  
 BEFORE CROSSING BROOK TO AVOID WATER DIVERSION
- 6" SDR35 CASHEATED SEWER PIPE - 14' LENGTHS

**PERCOLATION TEST DATA**  
 BY THE TOWN OF GLASTONBURY  
 DEPTH OF HOLE: 30"  
 MATERIAL: SAND, STONES, AND GRAVEL  
 GROUND WATER: NONE FOUND  
 RATE: 4 MINUTES PER INCH  
 DATE OF TEST: 5-6-68

**SEPTIC SYSTEM:**  
 42' LINEAL FEET OF TILE PER  
 BEDROOM LAID IN 3 FT. WIDE TRENCHES  
 FILLED WITH WASHED GRAVEL OR  
 BROKEN STONE FOR A DEPTH OF 18  
 INCHES. TRENCHES TO BE SPACED 12 FT.  
 C.O.C. MIN.

**APPROVED**  
 GLASTONBURY HEALTH DEPARTMENT  
 DATE 5-26-68 BY [Signature]

PROPOSED HOUSE IS SHOWN AS STAKED.  
 Certified to be substantially correct.  
 NO ZONING VIOLATIONS.

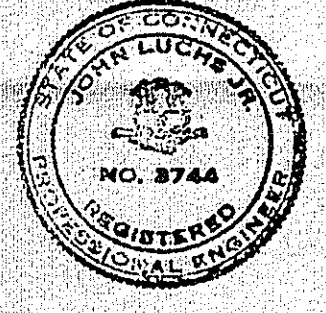

John J. Mozzochi Jr.

PLOT PLAN  
 PREPARED FOR  
 Y.D. MOREY AGENCY  
 GLASTONBURY, CONN.

JOHN J. MOZZOCHI & ASSOCIATES  
 CIVIL ENGINEERS  
 GLASTONBURY, CONN.  
 C-68-49-2  
 SCALE 1"=40' DATE 5-6-68

PROPOSED SEWER CONNECTION  
 39 STANLEY DRIVE  
 BRIAN STERLIE 860-805-7700  
 INSTALLER #005971  
 STEVE SLEEPER P-1 0288808-P1  
 MAY 10, 2022