

FILE: H:\DWG\Streets\Tryon St\PW-2114 BULKY WASTE VOLUME COUNTY 2020\PW-1811 Bulky Waste 2018 Presentation Plan.dwg USER: Steven Troy DATE: 6/3/2021

BULKY WASTE/TOWN OF GLASTONBURY RESERVED LAND
PROJECT/APPLICANT ZONE

1145 TRYON STREET
PROJECT ADDRESS

SPECIAL PERMIT TPZ CHAIRPERSON

DATE SPECIAL PERMIT APP'D DIRECTOR OF COMMUNITY DEVELOPMENT

FILE NO.

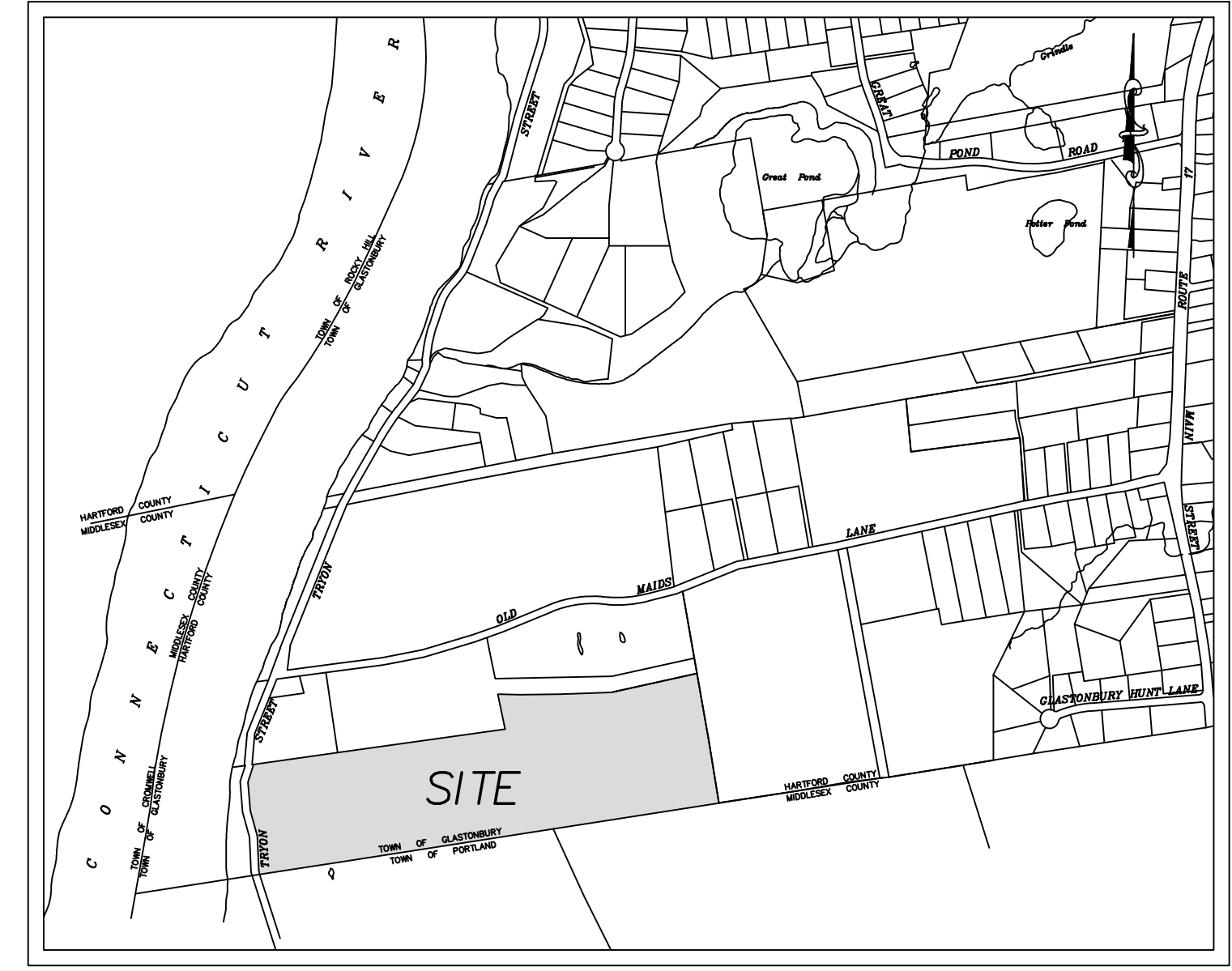

LOCATION MAP
SCALE: 1"=1000'

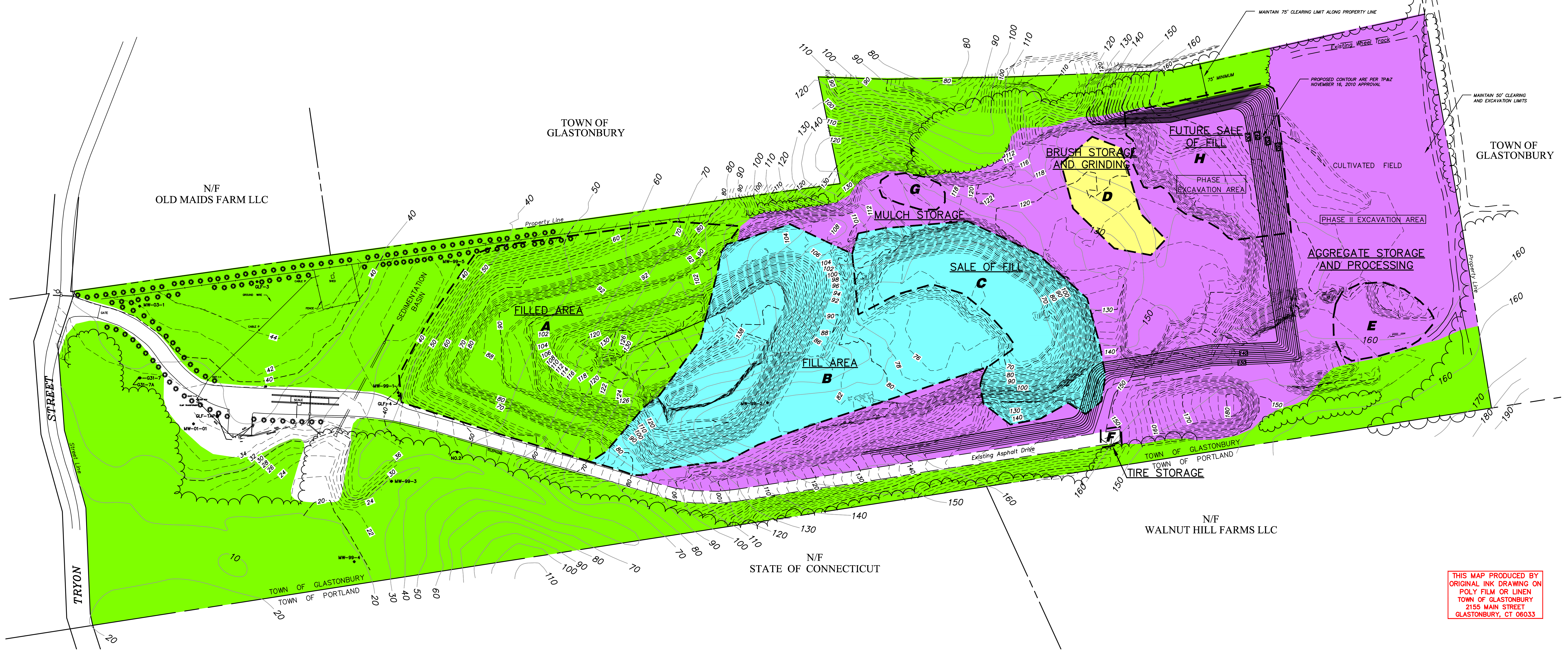

THIS MAP PRODUCED BY ORIGINAL INK DRAWING ON POLY FILM OR LINEN TOWN OF GLASTONBURY 2155 MAIN STREET GLASTONBURY, CT 06033

140 CONTOUR JULY 1978
50 CONTOUR SEPTEMBER 2020
48

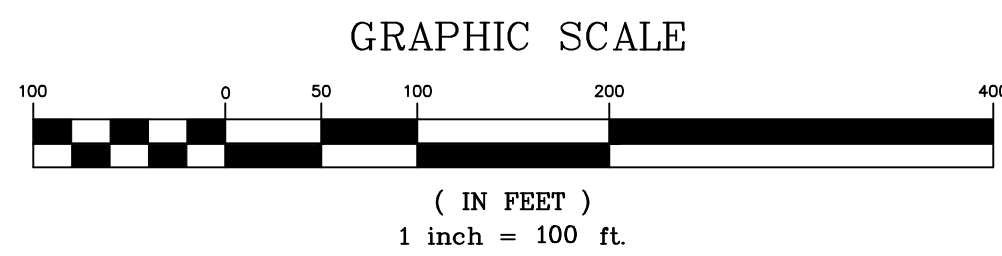

NOTE:
THE CONTOURS ABOVE ELEVATION 40 WERE OBTAINED BY AN ACTUAL FIELD SURVEY CONDUCTED IN AUGUST OF 2016 AND SUPPLEMENTED WITH ADDITIONAL SURVEY THROUGH SEPTEMBER 2020

Certified to be substantially correct
DANIEL A. PENNINGTON P.E. Reg. No. 20101

P.W. 2114

DRAWING ISSUE STATUS		
NO.	DESCRIPTION	DATE
1.	-----	----

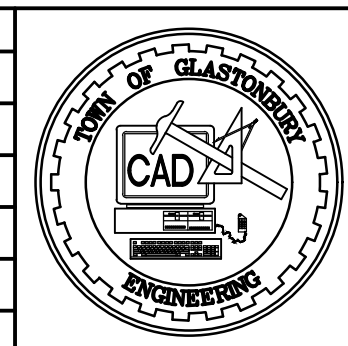

SCALE: AS SHOWN DATE: 6-1-2021
DRAWN BY: S.Troy
CHECKED BY: ---
APPROVED BY: ---
ST. FILE: ---
DO NOT SCALE THIS DRAWING. USE THE DIMENSIONS GIVEN. IF THERE ARE ANY DISCREPANCIES OR QUESTIONS, CONTACT THE TOWN OF GLASTONBURY, ENGINEERING OFFICE.

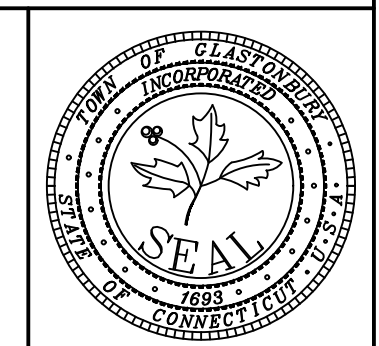
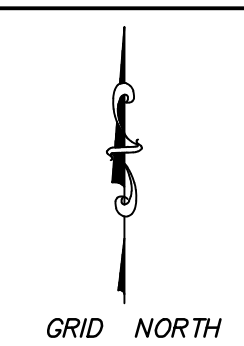

MAP DEPICTING
TOWN OF GLASTONBURY
BULKY WASTE DISPOSAL SITE
EXCAVATION AND FILL
2020 EXCAVATION PERMIT PLAN
LOCATED ON
1145 TRYON STREET
GLASTONBURY, CONNECTICUT