



CUSTOMER

MPD Firing Range Town Of
Manchester Officer Brian Hagen
Source: Internet Search

JOB LOCATION

130 Line Street,
Glastonbury, CT 06033

PHONE (PRIMARY)

(860) 705-2559
Note: Officer Brian Hagen

EMAIL ()

OTHER

TOWN OF MANCHESTER
LINCOLN CENTER 494 MAIN
STREET
Manchester, CT 06040

Floor Plan

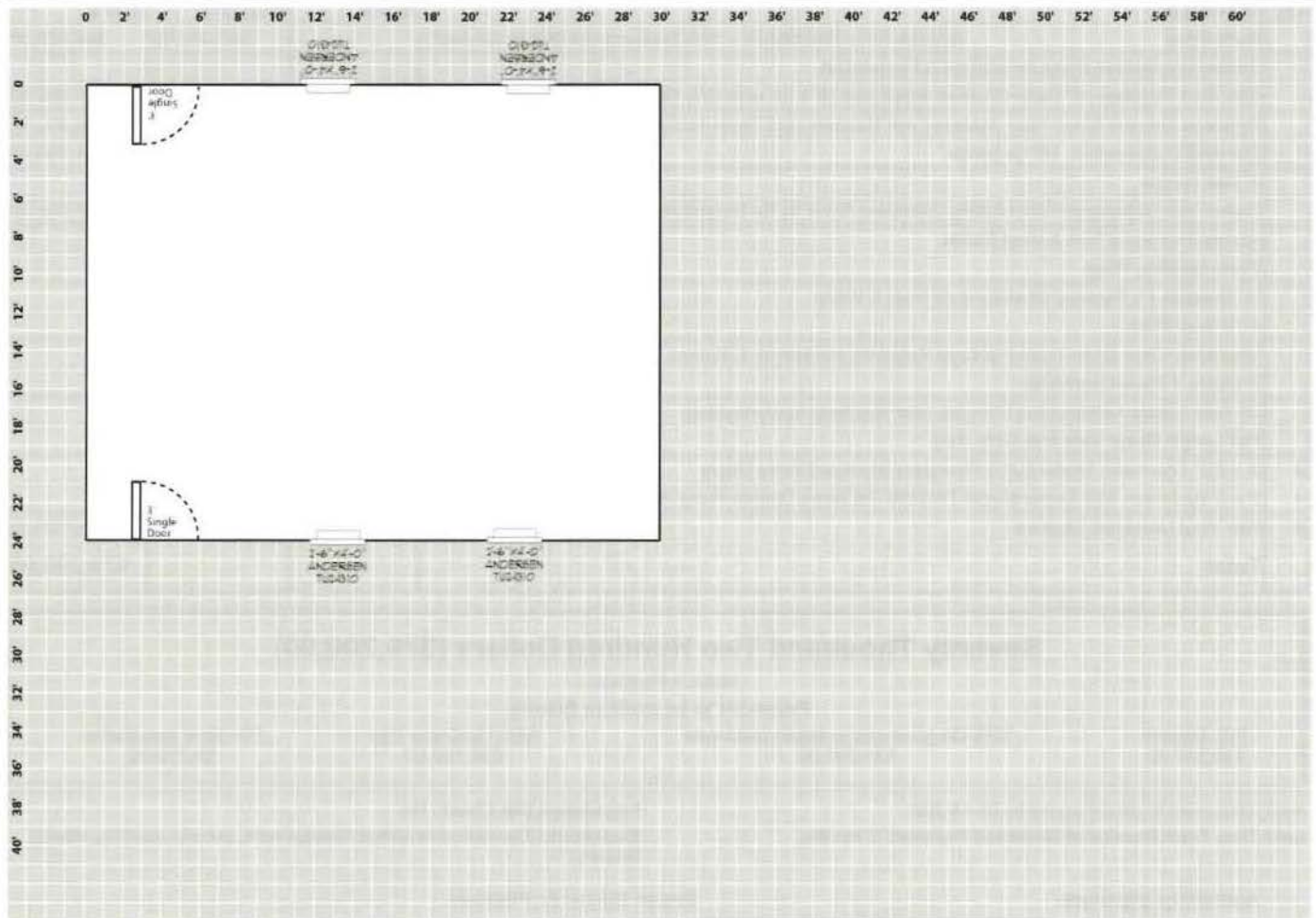

No. 6993 Date: 04-29-2021

Store: Ellington

1-800-628-2276 | www.greatcountrygarages.com



Type: Draft Ready to Review

Salesperson: Chris Vincelette

CUSTOMER

MPD Firing Range Town Of
Manchester Officer Brian Hagen
Source: Internet Search

JOB LOCATION

130 Line Street,
Glastonbury , CT 06033

PHONE (PRIMARY)

(860) 705-2559
Note: Officer Brian Hagan

EMAIL ()

OTHER

TOWN OF MANCHESTER
LINCOLN CENTER 494 MAIN
STREET
Manchester, CT 06040

Elevations



No. 6993 Date: 04-29-2021

Store: Ellington

1-800-628-2276 | www.greatcountrygarages.com



Type: Draft Ready to Review

Salesperson: Chris Vincelette

CUSTOMER

MPD Firing Range Town Of
Manchester Officer Brian Hagen
Source: Internet Search

JOB LOCATION

130 Line Street,
Glastonbury , CT 06033

PHONE (PRIMARY)

(860) 705-2559
Note: Officer Brian Hagan

EMAIL ()

OTHER

TOWN OF MANCHESTER
LINCOLN CENTER 494 MAIN
STREET
Manchester, CT 06040

24x30 Roosevelt A-Frame-Style Single Story Garage

Qty	Description	Notes	Regular \$	Sale \$
	Built Price Regular Price \$48,889.00 - 10% Discount (\$4,889.00 Savings)		\$48,889.00	\$44,000.00
	Sealed Engineered Plans for Garage & Foundation			
	Site Work Package: 6" Deep Crushed stone pad 28' x 34' with (20) 16" Diameter Concrete Piers			\$12,000.00
	Pressure Treated Wood Floor System (4x4 Runners, 2x8 Floor Joists 16" o.c., 3/4" Plywood)			\$8,900.00
	2x6 Wall Construction, 16" on center			\$1,300.00
	8' Wall Height			
	CertainTeed Monogram Vinyl Siding (Standard Color To Be Determined)			\$3,500.00
	Aluminum Fascia/Trim & Vinyl Soffits			
	Tyvek Building Wrap			
	1/2" Douglas Fir Plywood Sheathing on Roof & Walls			
	4-12 Roof Pitch			
	Upgraded Clear Span Truss Package Requiring No Interior Columns			
	1' Gable & Eave Overhangs			
	30 Year Tamko Architectural Shingles over Synthetic Underlayment	Color: TBD		
	Full Length Ridge Vent and Soffit Vent			
2	3' x 6'8" Thermatru Model S210 Fiberglass Insulated Entry Doors			
4	2' x 3' Andersen 400 Series Model TW2036 Tilt Wash Double Hung Windows (GBG)			
4	Pair Vinyl Louvered Shutters			\$500.00
	Total			\$70,200.00

Seventy Thousand Two Hundred Dollars (\$70,200.00)

[Make a Payment »](#)

Payments to be made as follows:

15% Deposit
\$10,530.00

30% On go-ahead to obtain build date
\$21,060.00

50% On Crane Day
\$35,100.00

5% Upon completion
\$3,510.00

Note: Document is good if signed by 05-14-2021.

Lead Time From Receipt of Go-Ahead Payment: 2 months

Foundation Site Check: No

Exclusions: General construction management, permits, painting, interior finishing

Authorized Signature: _____ Everett Skinner IV, President

Customer Signature: _____

Dated: _____



Reference : Bid #20/21-67

City of Hartford Police Department – John Cavanna (20' x 30' Double Wide)
50 Jennings Road, Hartford CT 06120
(860)398-8929
jcavhpd@aol.com

