

## HEBRON AVENUE/NEW LONDON TURNPIKE ROUNDABOUT

This construction project was completed in November of 2017 and consisted of replacing an existing traffic signal with a modern roundabout at the intersection of Hebron Avenue and New London Turnpike. The new roundabout safely accommodates motor vehicles, pedestrians, and cyclists simultaneously. The geometry on all four roundabout approaches is configured to reduce vehicular speeds to 15-18 miles per hour. Doing so allows for easy and safe pedestrian crossings from the sidewalks on both sides of all approach roads. Narrow travel lanes, combined with slow vehicular speeds and the existence of a mid-crossing island of refuge, make pedestrian crossings simple and safer as compared to the prior signalized condition. Likewise, cyclist transport through the intersection is made easier and safer. Experienced cyclists are able to ride through the roundabout with vehicular traffic due to reduced speeds and inexperienced cyclists are provided with ramps to the sidewalk where they can use the sidewalks and pedestrian crossing points. Overall congestion through the intersection has been dramatically decreased, making the intersection safer and more comfortable for all three transportation modes.

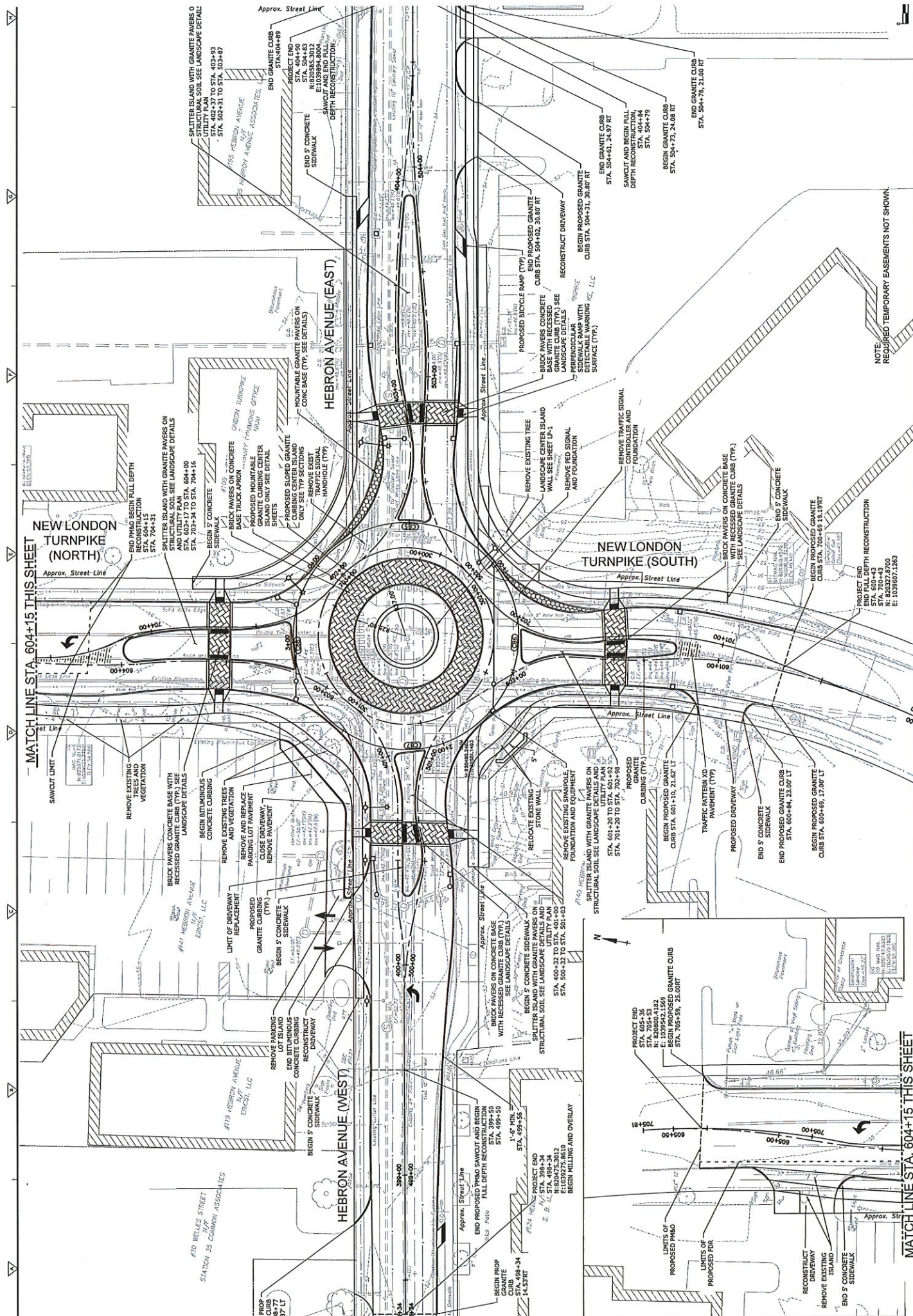



MATCH LINE STA. 604+15 THIS SHEET

MATCH LINE STA. 604+15 THIS SHEET

DESIGNED BY:	Z. HELLMAR
DRAWN BY:	J. CABRERA
CHECKED BY:	J. BALSZKUS
IN CHARGE:	J. BALSZKUS
DATE:	JULY 2016
PROJECT NO.:	111
DATE:	JULY 2016
REVISIONS:	
NO.	DESCRIPTION
1	CHD
2	CHD
3	CHD
4	CHD
5	CHD
6	CHD
7	CHD
8	CHD
9	CHD
10	CHD
11	CHD
12	CHD
13	CHD
14	CHD
15	CHD
16	CHD
17	CHD
18	CHD
19	CHD
20	CHD
21	CHD
22	CHD
23	CHD
24	CHD
25	CHD
26	CHD
27	CHD
28	CHD
29	CHD
30	CHD
31	CHD
32	CHD
33	CHD
34	CHD
35	CHD
36	CHD
37	CHD
38	CHD
39	CHD
40	CHD
41	CHD
42	CHD
43	CHD
44	CHD
45	CHD
46	CHD
47	CHD
48	CHD
49	CHD
50	CHD
51	CHD
52	CHD
53	CHD
54	CHD
55	CHD
56	CHD
57	CHD
58	CHD
59	CHD
60	CHD
61	CHD
62	CHD
63	CHD
64	CHD
65	CHD
66	CHD
67	CHD
68	CHD
69	CHD
70	CHD
71	CHD
72	CHD
73	CHD
74	CHD
75	CHD
76	CHD
77	CHD
78	CHD
79	CHD
80	CHD
81	CHD
82	CHD
83	CHD
84	CHD
85	CHD
86	CHD
87	CHD
88	CHD
89	CHD
90	CHD
91	CHD
92	CHD
93	CHD
94	CHD
95	CHD
96	CHD
97	CHD
98	CHD
99	CHD
100	CHD

CONSTRUCTION PLAN

TOWN OF GLASTONBURY, CONNECTICUT  
 INTERSECTION IMPROVEMENT  
 HEBRON AVENUE ROUNDABOUTS:  
 NEW LONDON TURNPIKE



111 Putnam Place, Suite 100  
 Glastonbury, CT 06033  
 Tel: (860) 258-7610

PROJECT NO. 111  
 DATE: JULY 2016

REVISIONS:





