

PHASE 3 - STAGE 2A WORK ACTIVITIES

1. LOTCIP PROJECT (LOT/CP 0053-001) SHALL CLOSE HEBRON AVENUE EASTBOUND AT NEW LONDON TPKE.
2. MAINTAIN ONE NORTHBOUND LANE ON HOUSE ST. MAINTAIN PHASE 2 SOUTHBOUND CLOSURE.
3. CONSTRUCT NORTHERN HALF OF WESTERN LEG OF HEBRON AVENUE APPROACH, HOUSE STREET SPLITTER ISLAND, AND COMPLETE WORK IN NORTHWEST CORNER.
4. MAINTAIN ACCESS TO ALL DRIVEWAYS AND ADJACENT BUSINESSES ON HEBRON AVENUE.

INSTALL NORTH OF MELROSE ST AND PLACE BARRICADES TO CLOSE HOUSE ST SOUTHBOUND

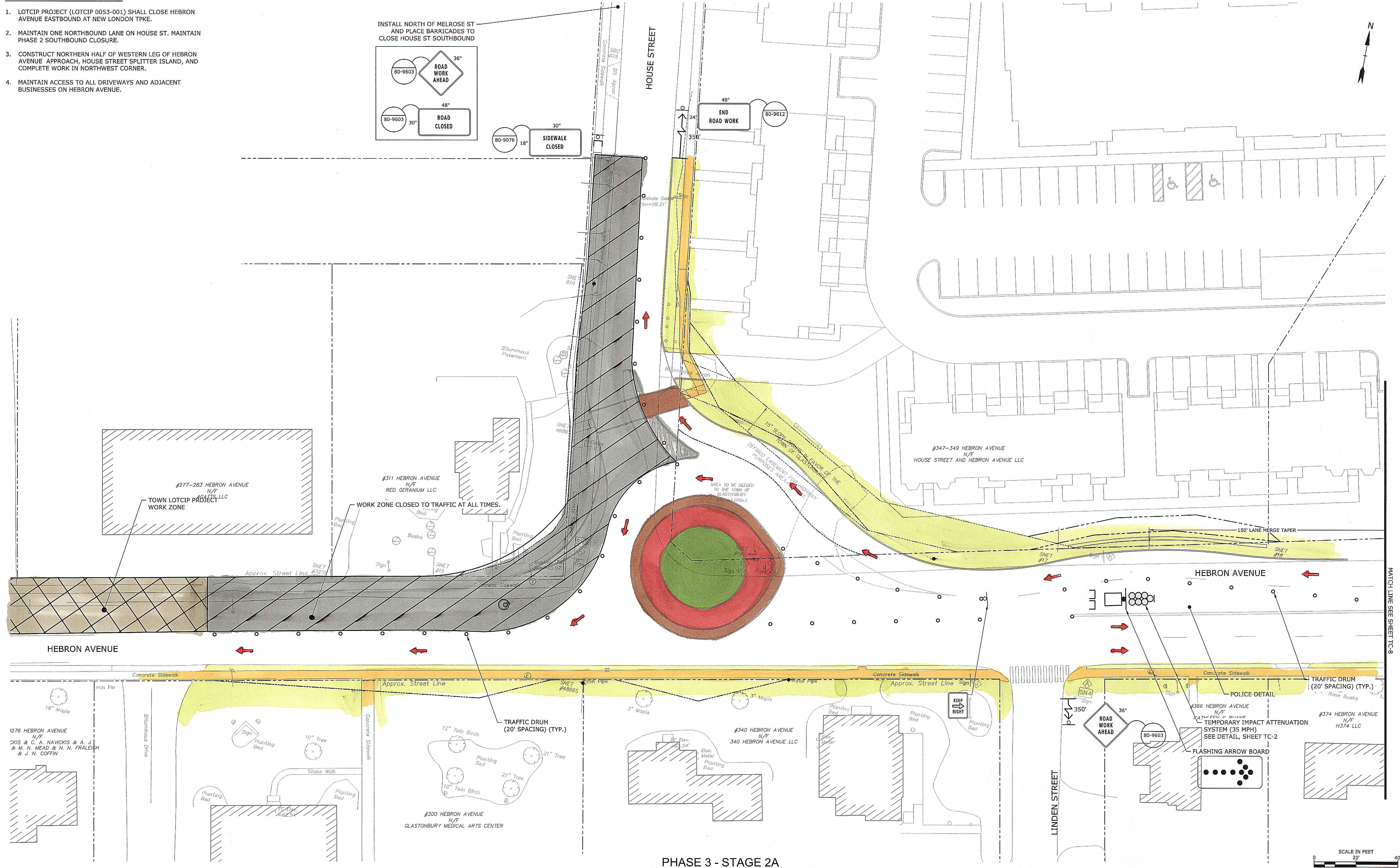
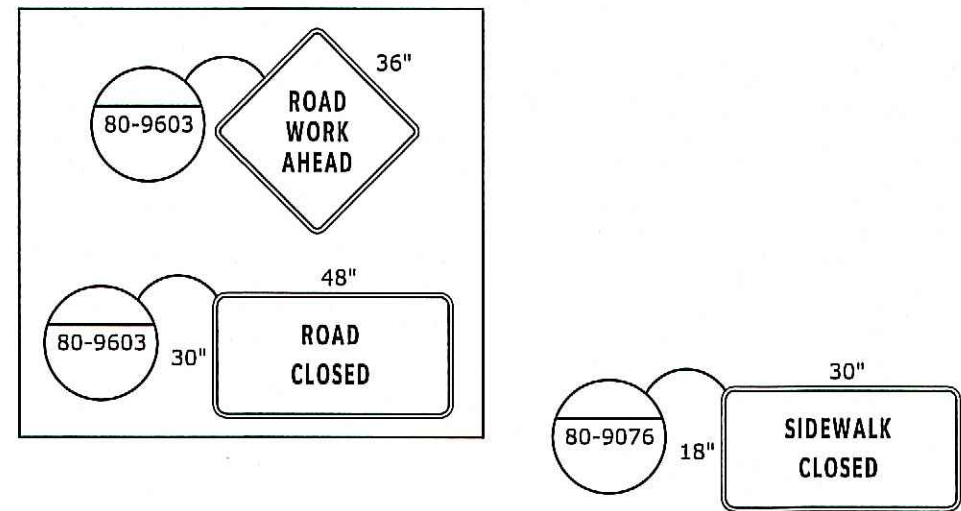

PHASE 3 - STAGE 2A

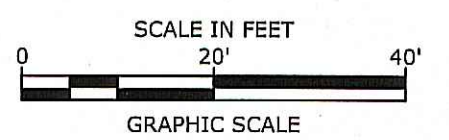

REV. NO.	DATE	DRWN	CHKD	REMARKS

DESIGNED BY: TJW
 DRAWN BY: TJW
 SHEET CHK'D BY: COG
 CROSS CHK'D BY:
 APPROVED BY:
 DATE: NOV 7, 2017

CDM Smith
 111 Founders Plaza, Suite 1600
 East Hartford, CT 06108
 Tel: (860) 528-7618

Tighe & Bond
 www.tighebond.com
 213 Court Street, Suite 900
 Middletown, CT 06457
 (860) 704-4760

TOWN OF GLASTONBURY, CONNECTICUT
 INTERSECTION IMPROVEMENT
**HEBRON AVENUE ROUNDABOUT:
 HOUSE STREET**

**TEMPORARY TRAFFIC CONTROL PLAN -
 PHASE 3 - STAGE 2A**

STATE PROJECT NO. 0053-0193
 FILE NAME: C1108-C-401-MPT.dwg
 SHEET NO.
TC-6

CDM SMITH, ALL RIGHTS RESERVED. THESE DOCUMENTS AND DESIGN PROVIDED BY PROFESSIONAL SERVICE. INCORPORATED HEREIN ARE THE PROPERTY OF CDM SMITH AND ARE NOT TO BE USED, IN WHOLE OR IN PART, FOR ANY OTHER PROJECT WITHOUT THE WRITTEN AUTHORIZATION OF CDM SMITH.